

**TF JACKSON**

PORTABLE ACCOMMODATION

TEL: 01298 79753

[WWW.JACKSON-GROUP.CO.UK](http://WWW.JACKSON-GROUP.CO.UK)

*Assembly manual*

## *Tools needed*

To unpack bundle



14mm allen key



30mm spanner key

To assemble posts



High speed drill with  
12mm allen key

To fit panels



14mm and 17mm spanner keys

## Tools needed

For finishing

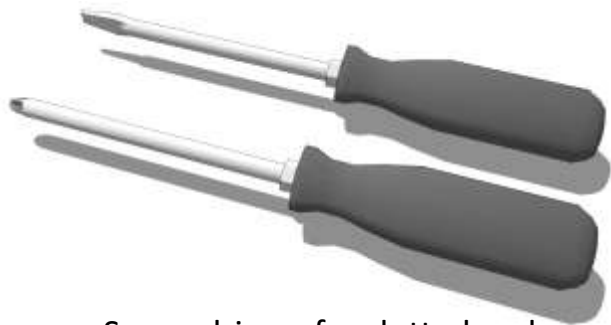

Screw drivers for slotted and cross head screws

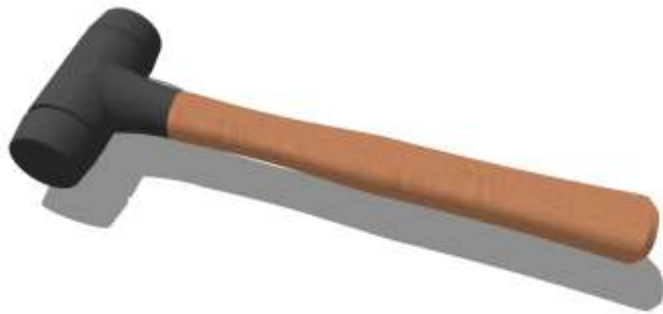

Hammer



Crowbar



Silicon putty

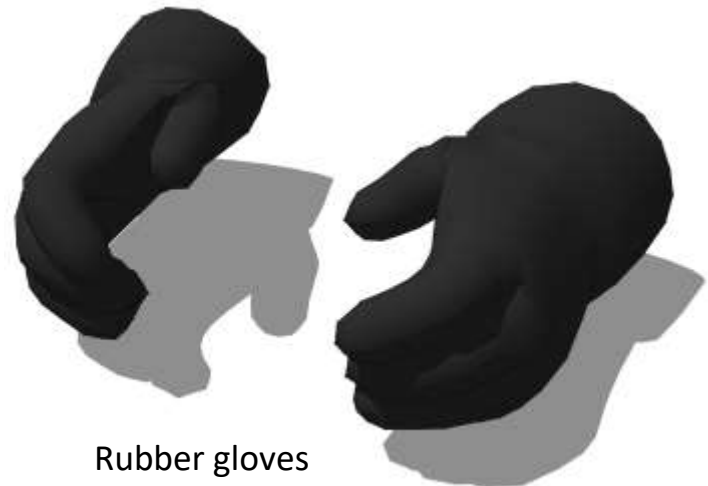

Rubber gloves



**WARNING:**

Do not handle the bundle with forklift truck or side stacker





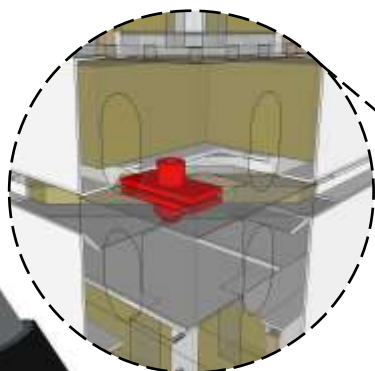

Remove all the screws locking the corner castings of the kit

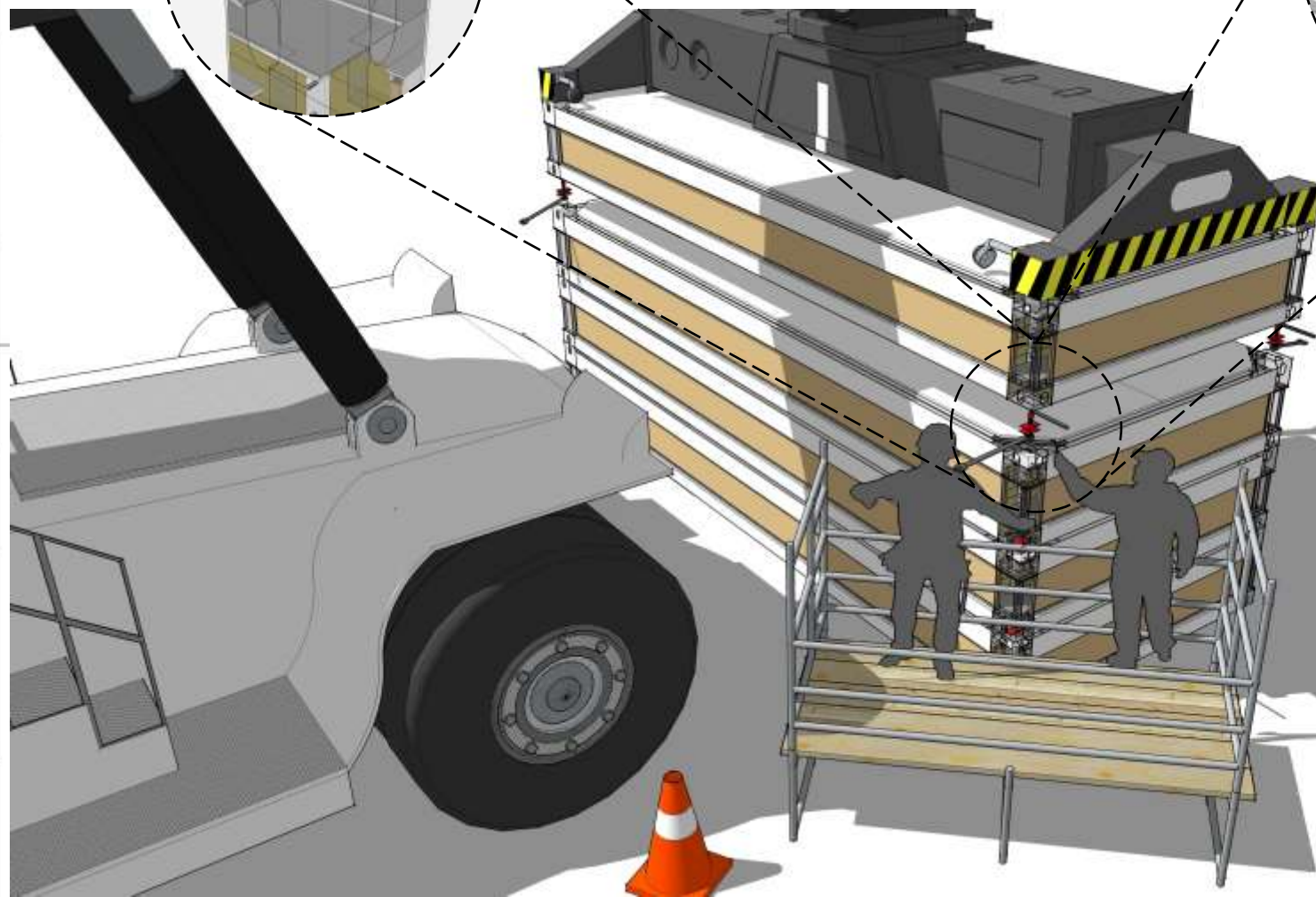
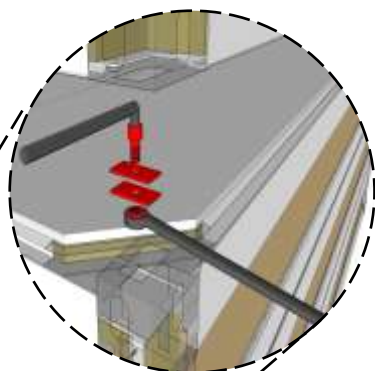

Do not lift more than 1 kit at a time



Position the kit in the assembly area

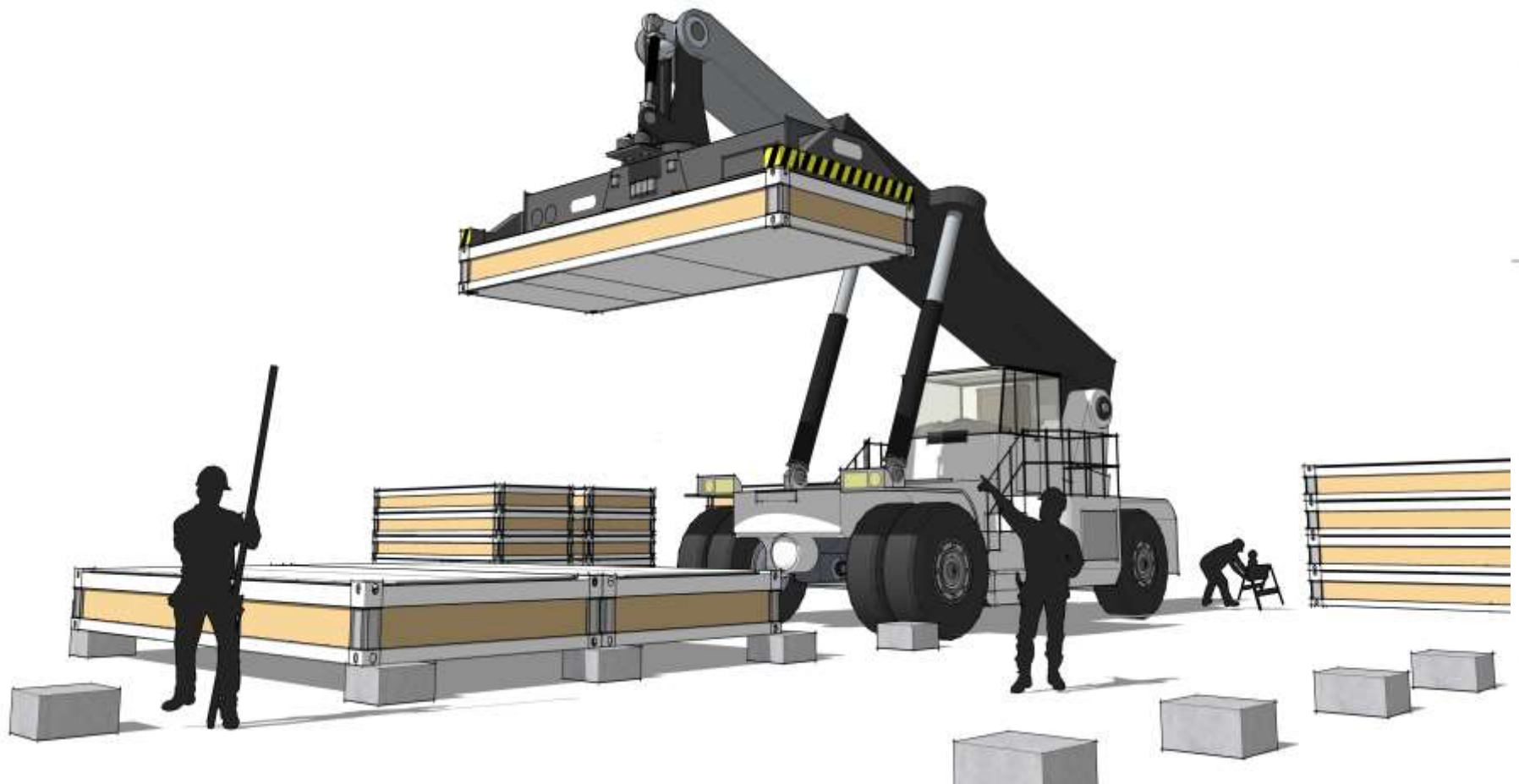



Remove the caps sealing the hole of the roof drain pipes

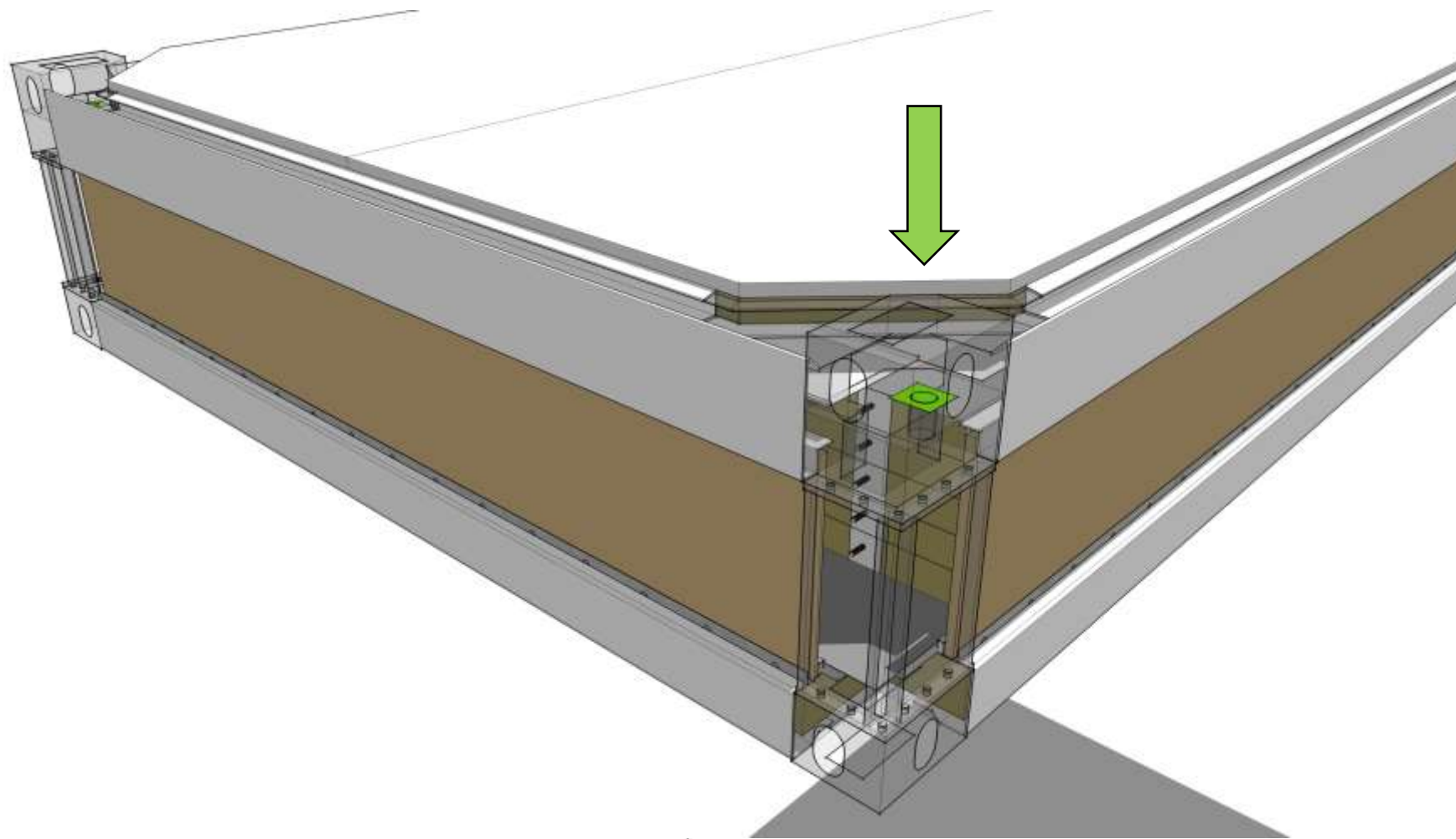

Remove the screws locking the bundling columns

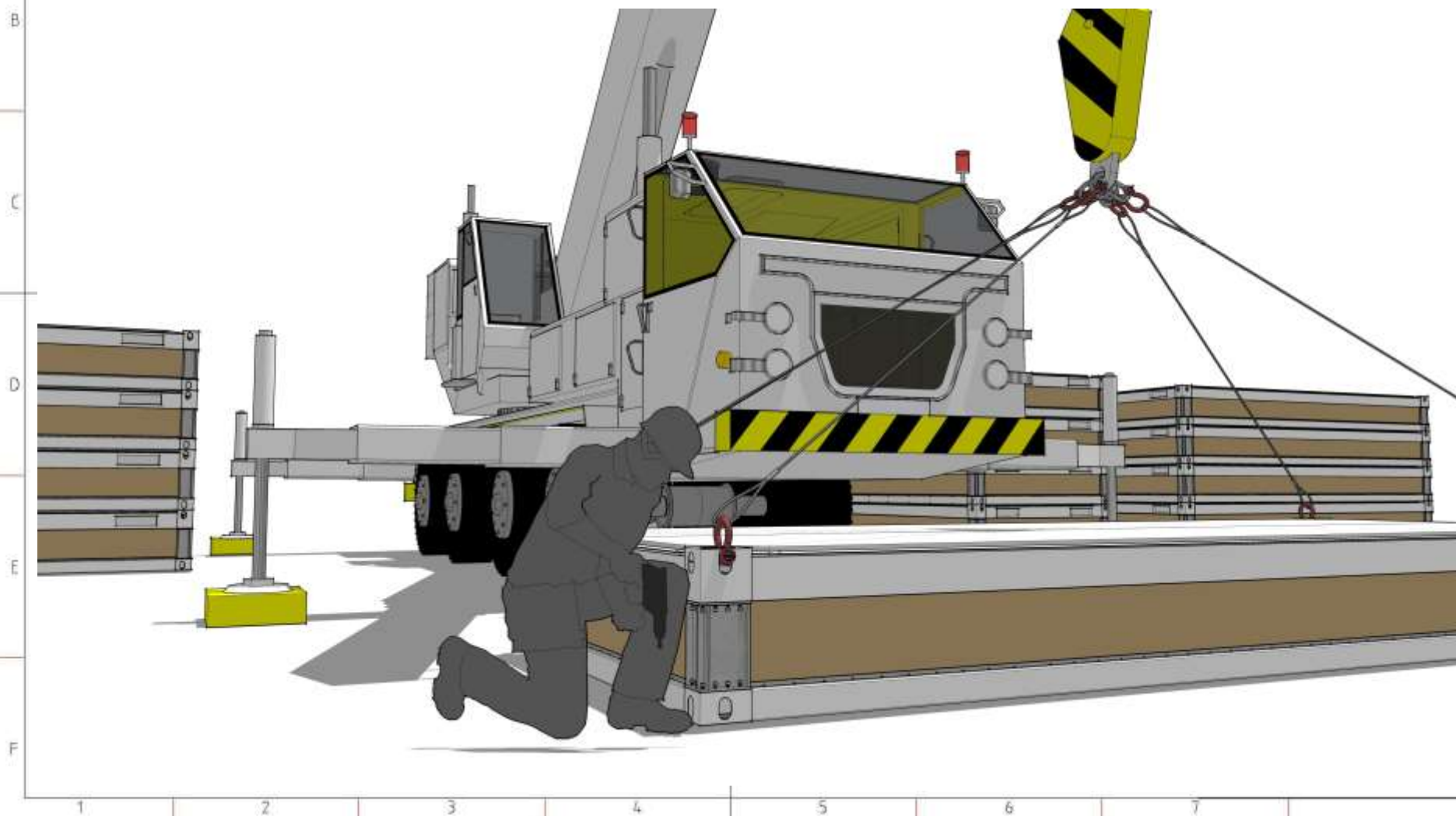

Lift the roof through the holes of the corner castings

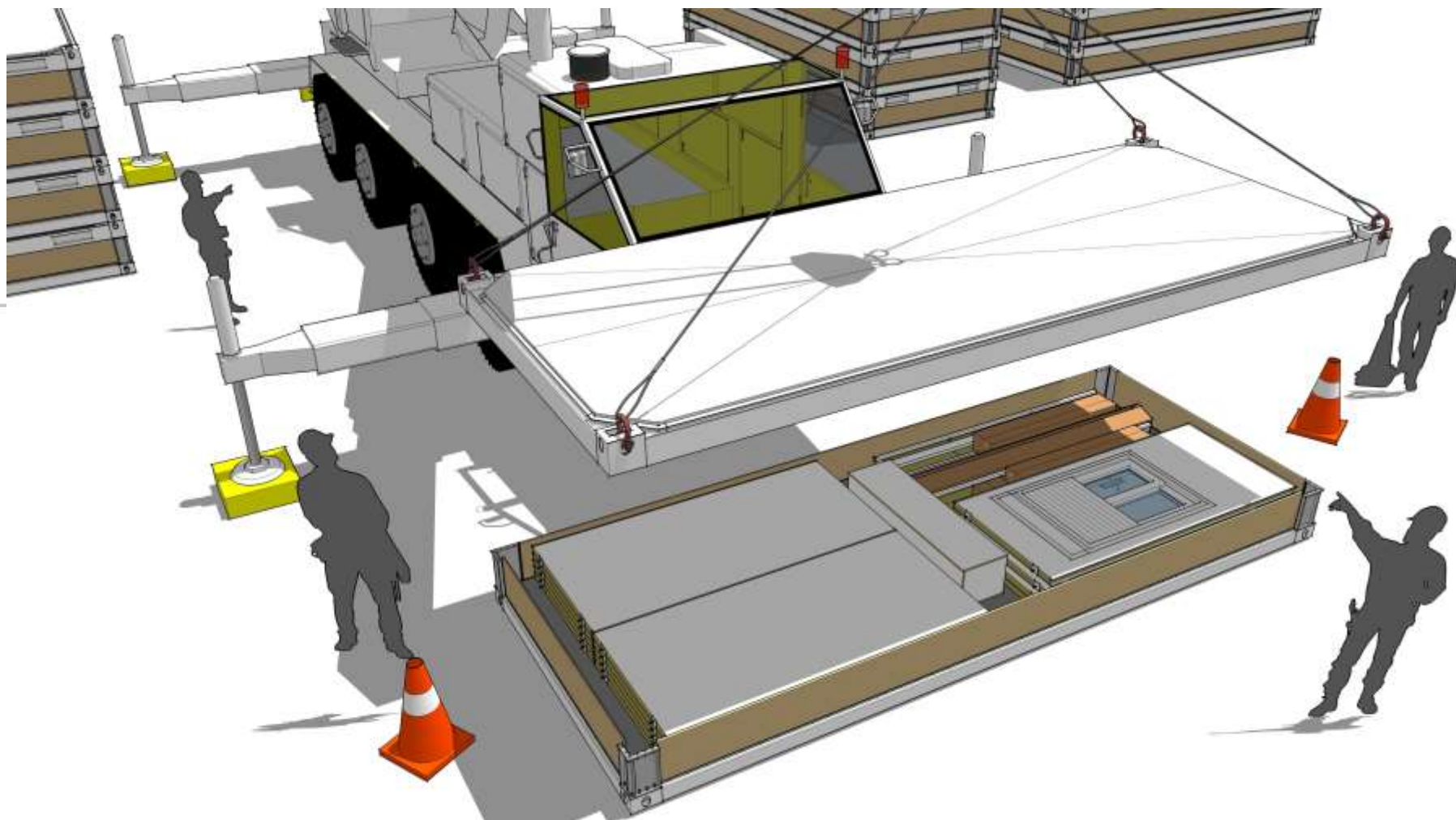

The kit contains all necessary components for a proper assembly

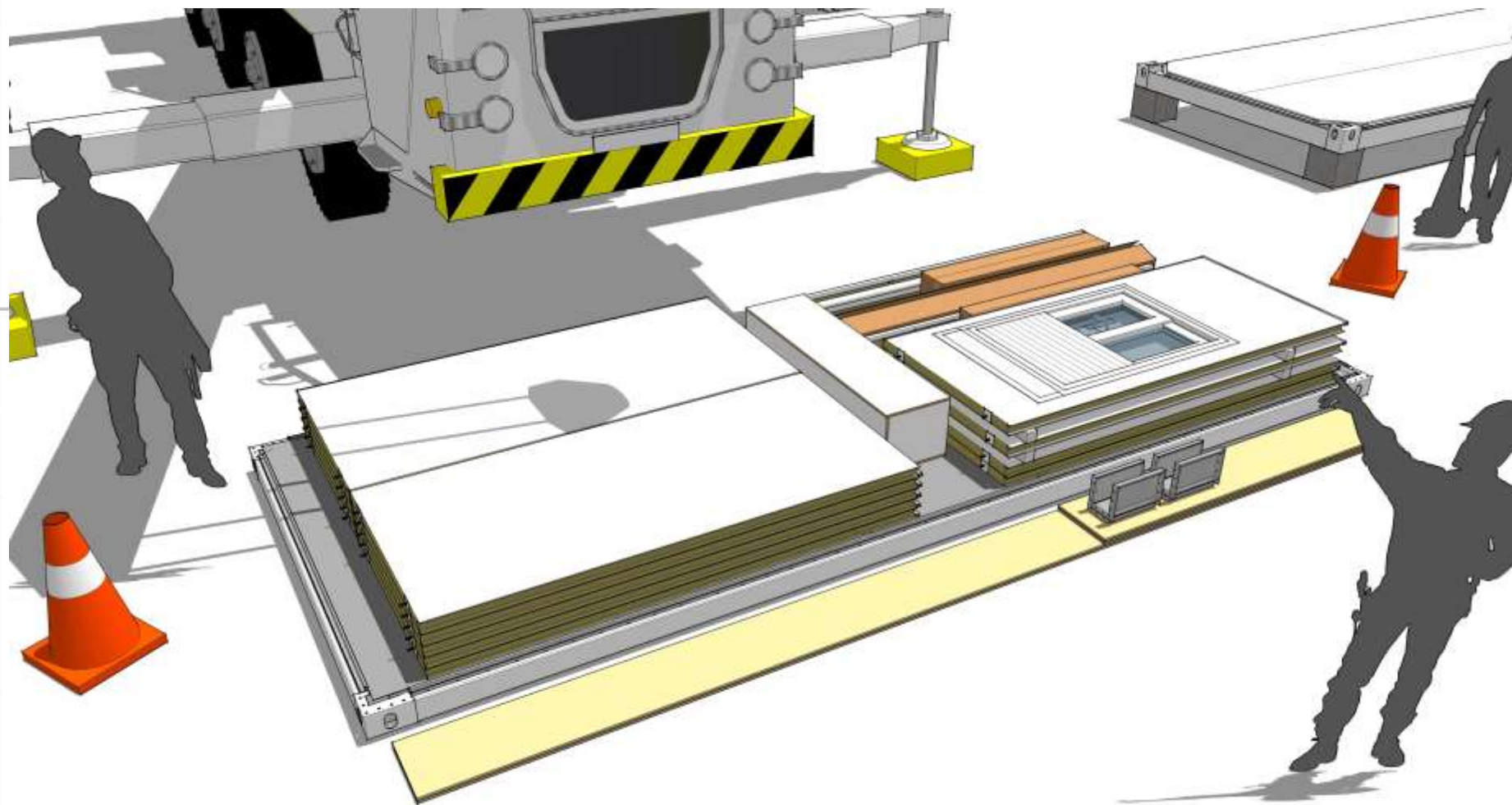



Remove all the components from the base

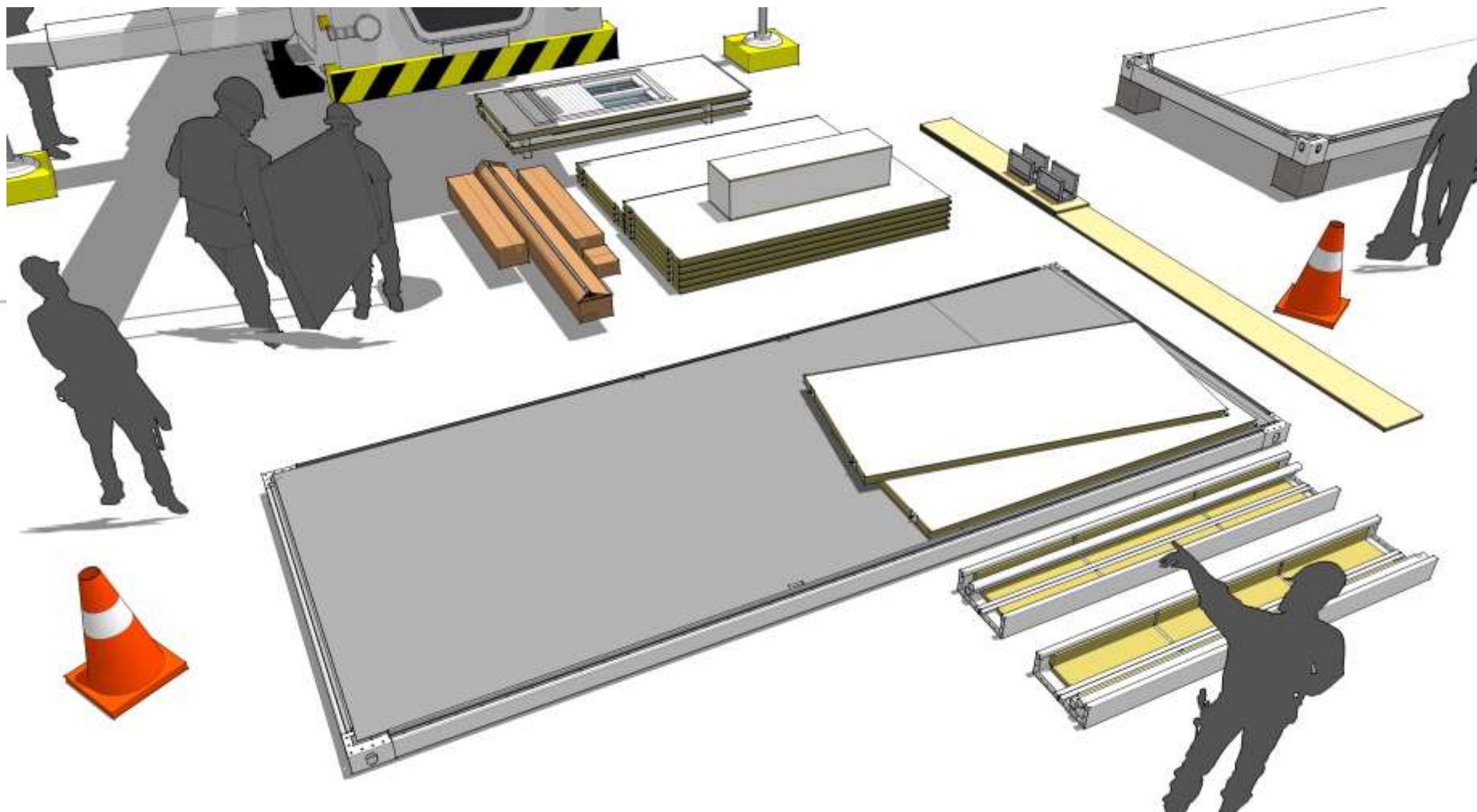



Position the corner posts

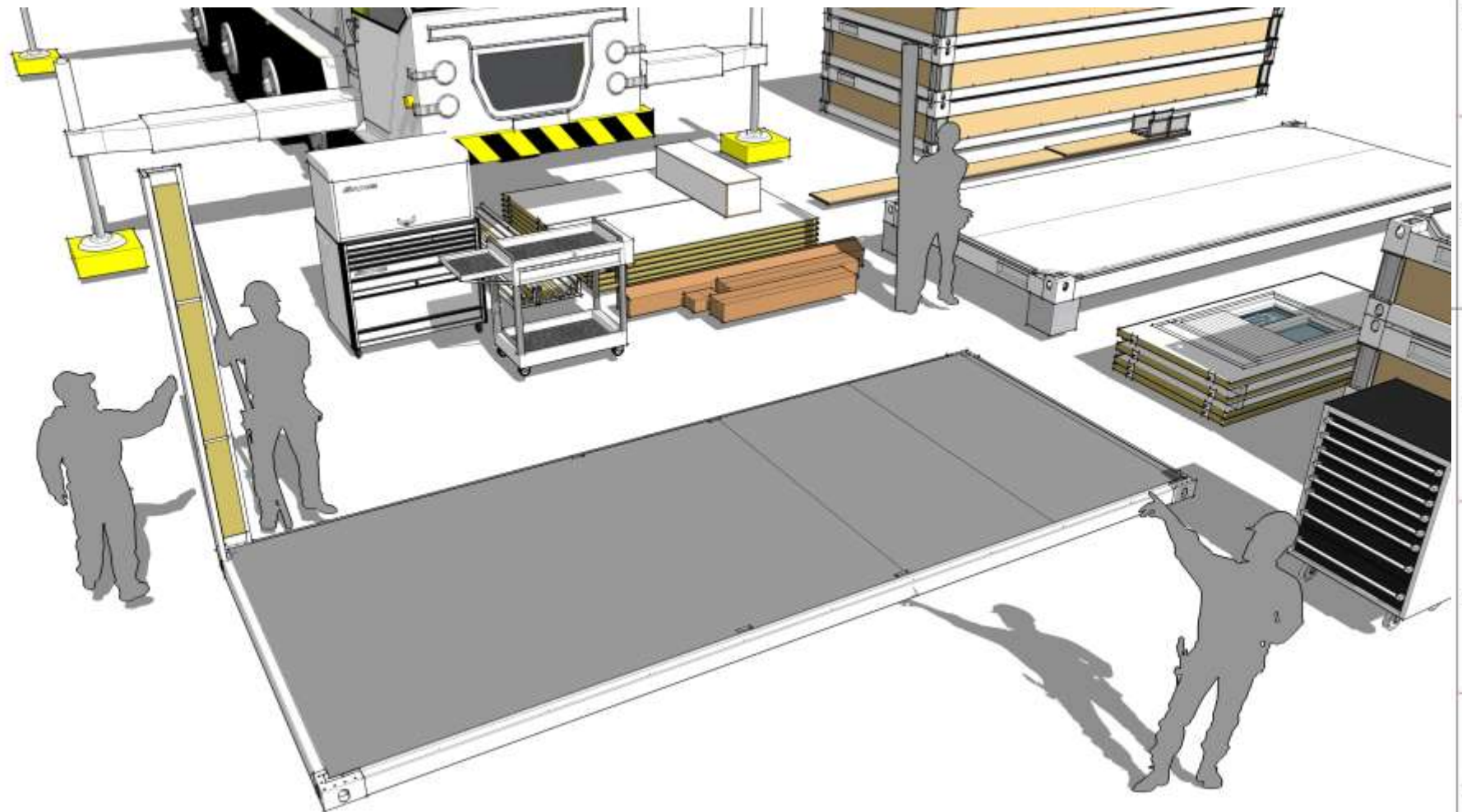

Fix the corner post by using M12 x 40 screws. Keep it loose to allow adjustment when installing the roof



Insert 4 threaded pins, one on each corner of roof frame  
– this is for easy corner posts to roof frame installation

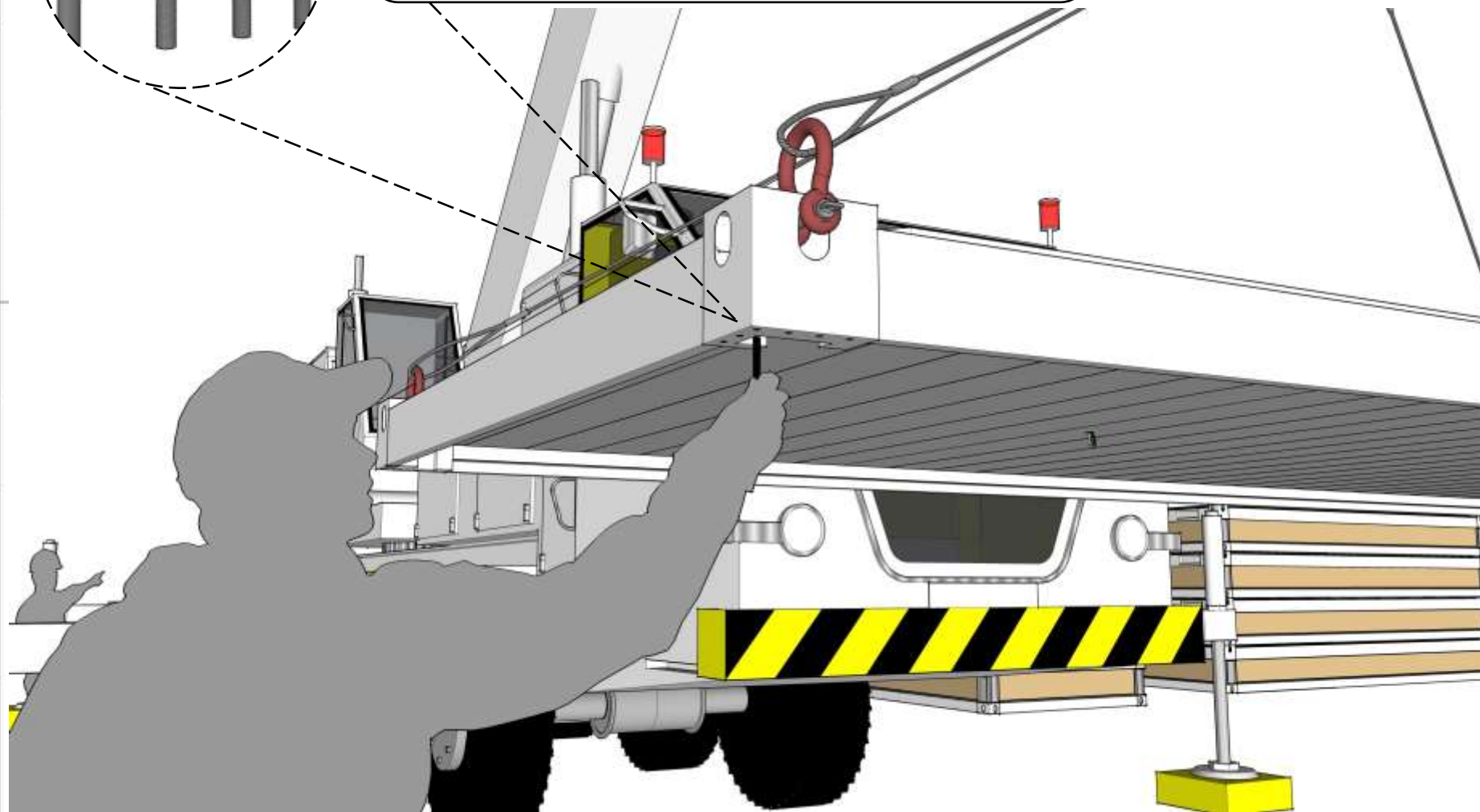



Position the roof frame

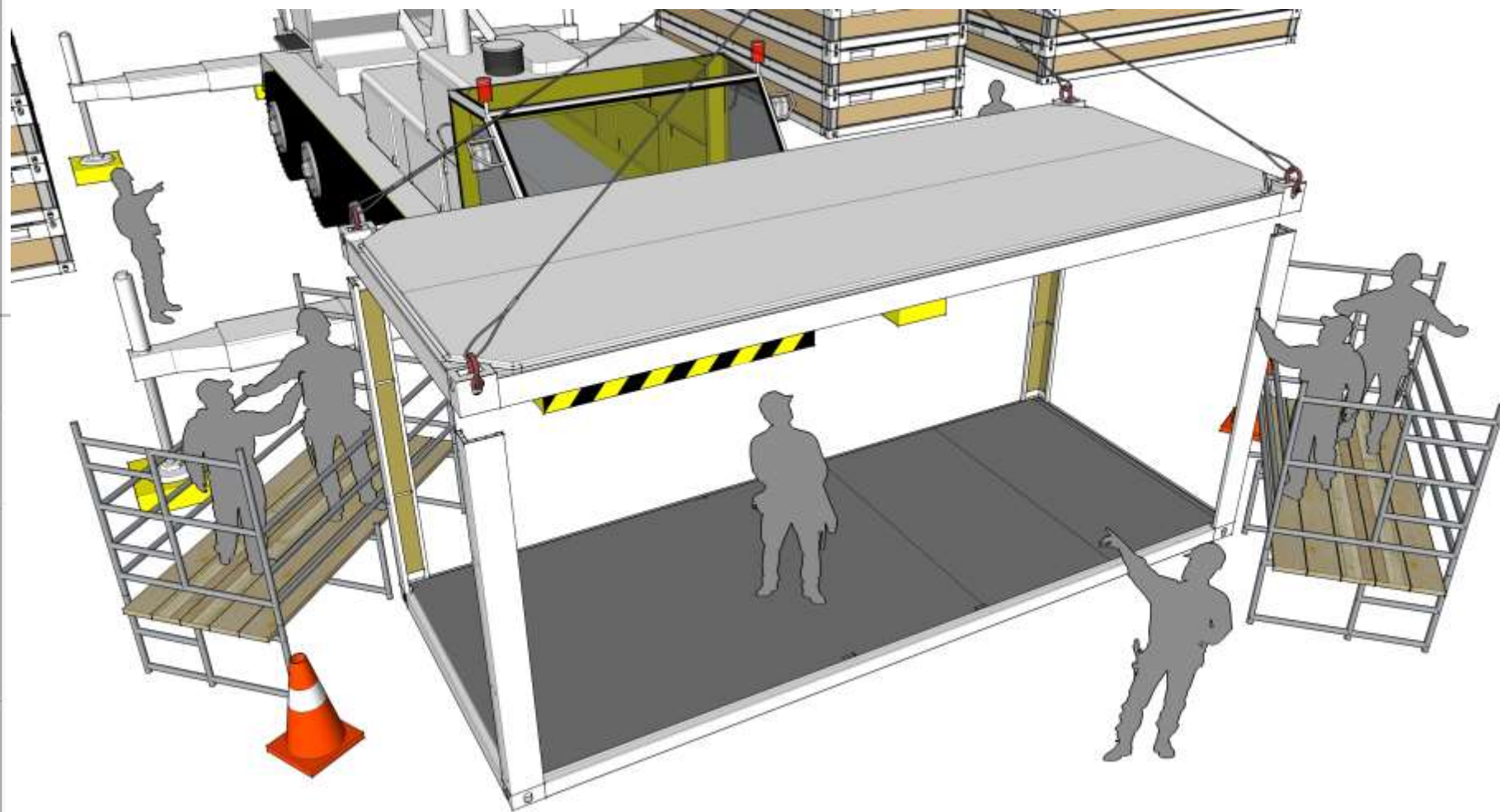

Once the roof frame is set, tighten the nut of the threaded pins

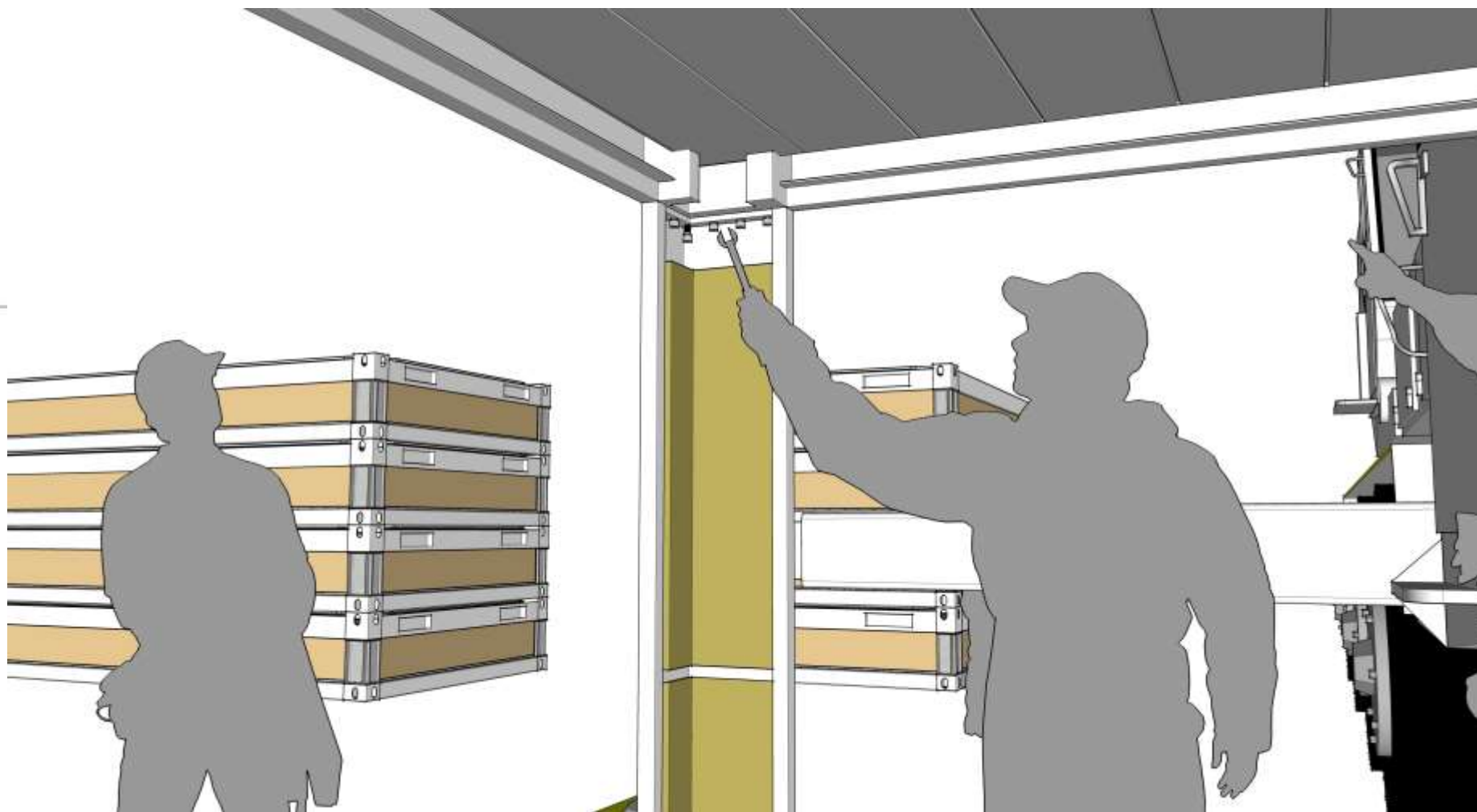



Tighten all screws on all 4 corner posts

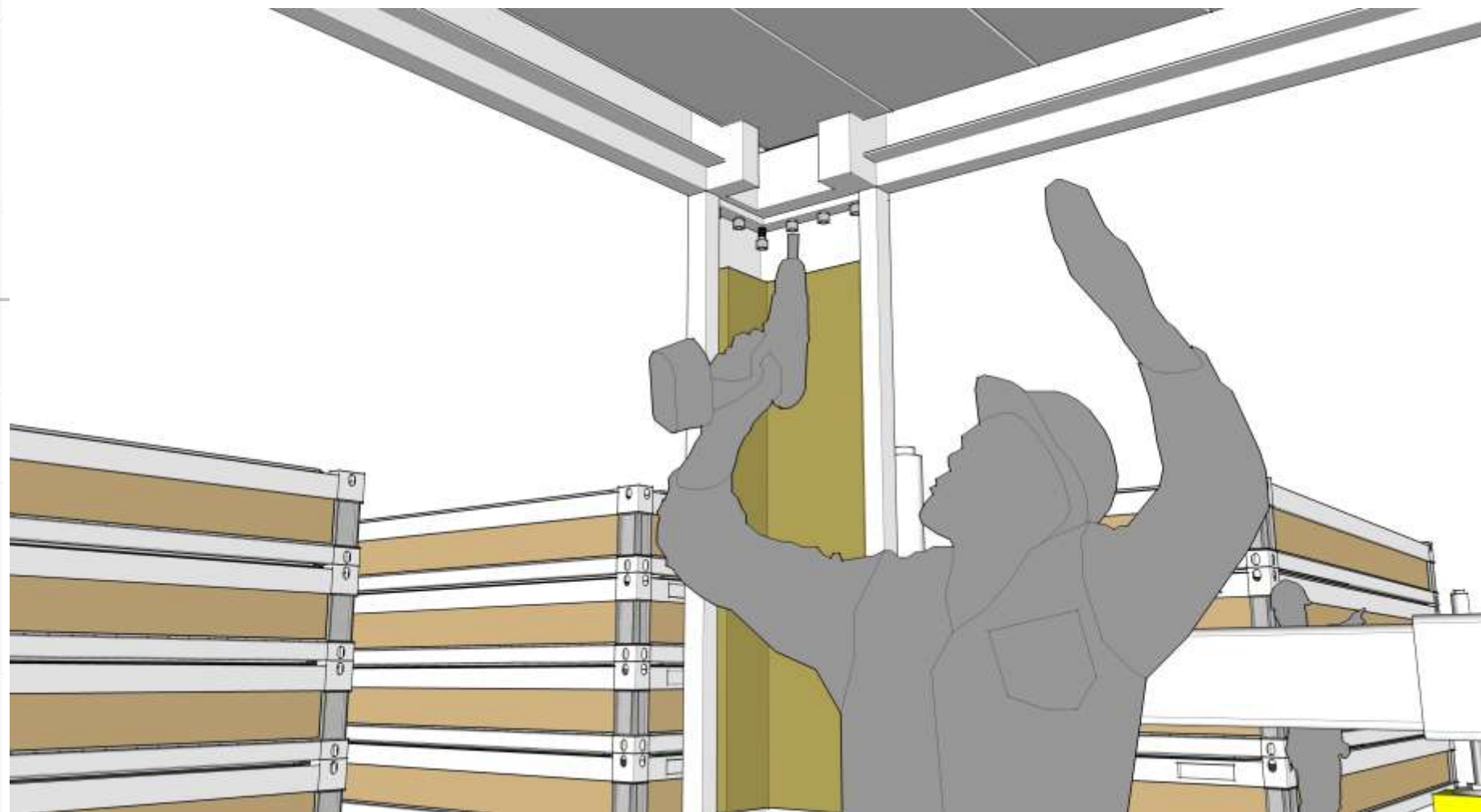

Seal the bottom joints between the floor frame and corner posts with silicon

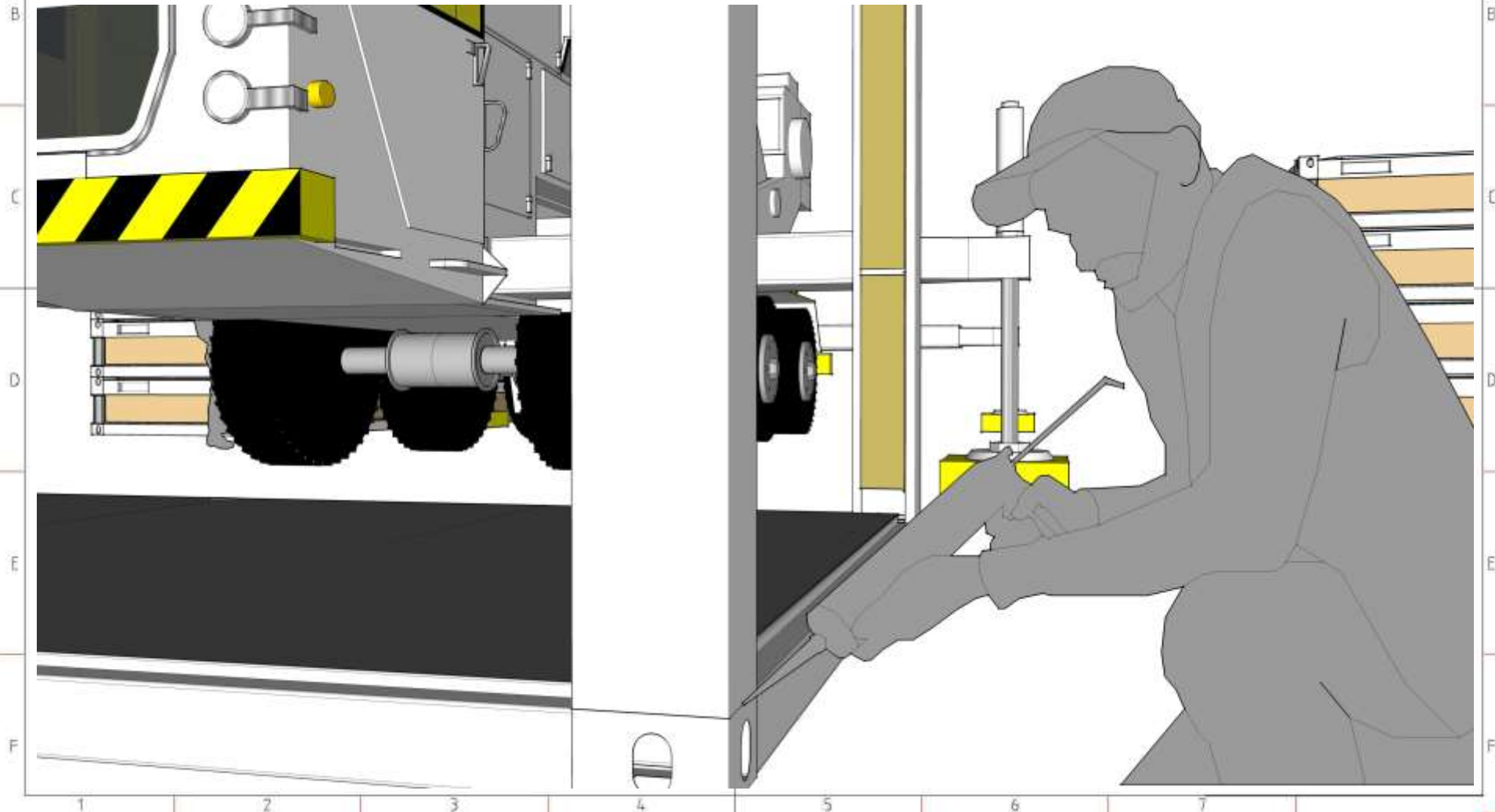

Seal the top joints between the roof frame and corner posts with silicon

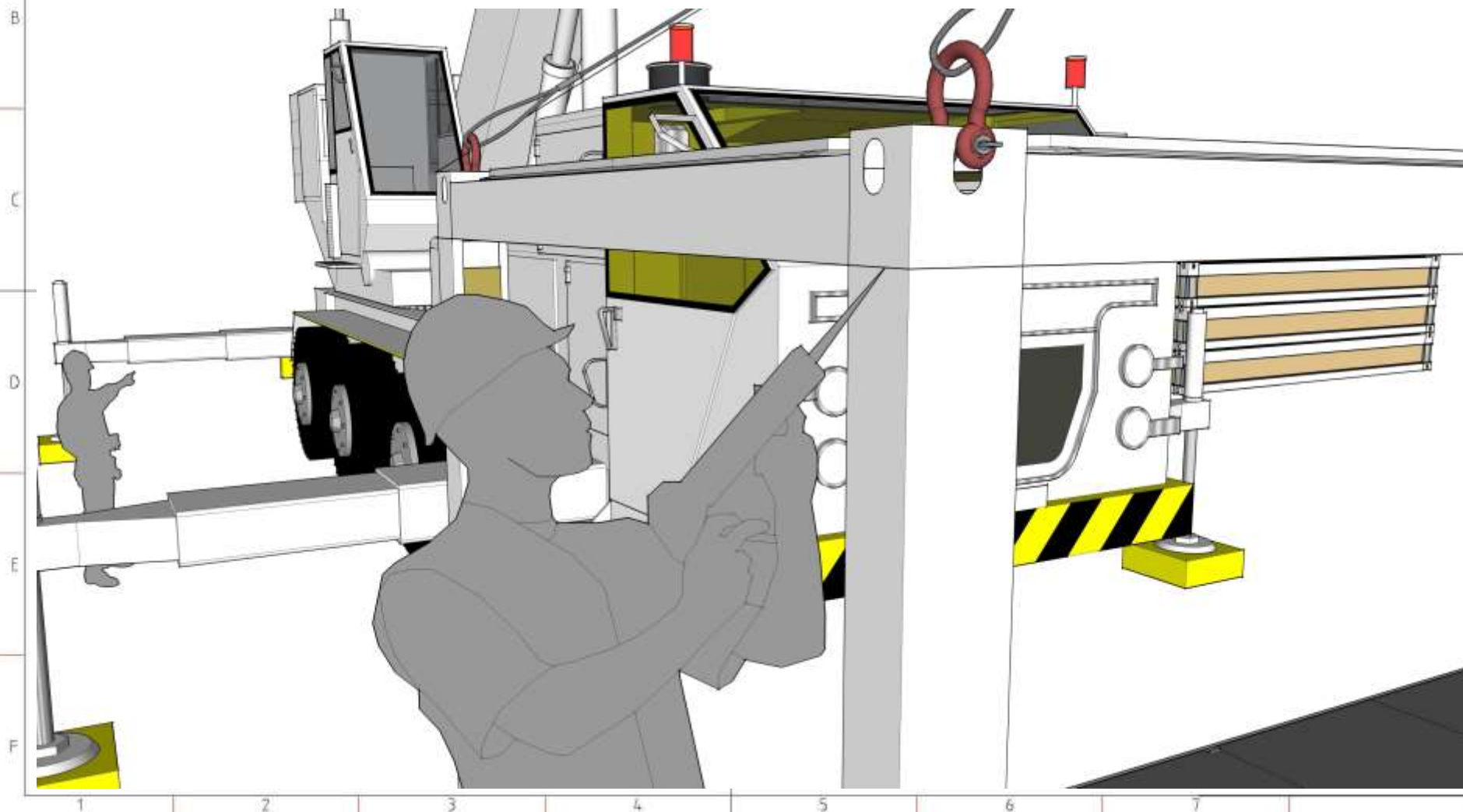

Approved layout

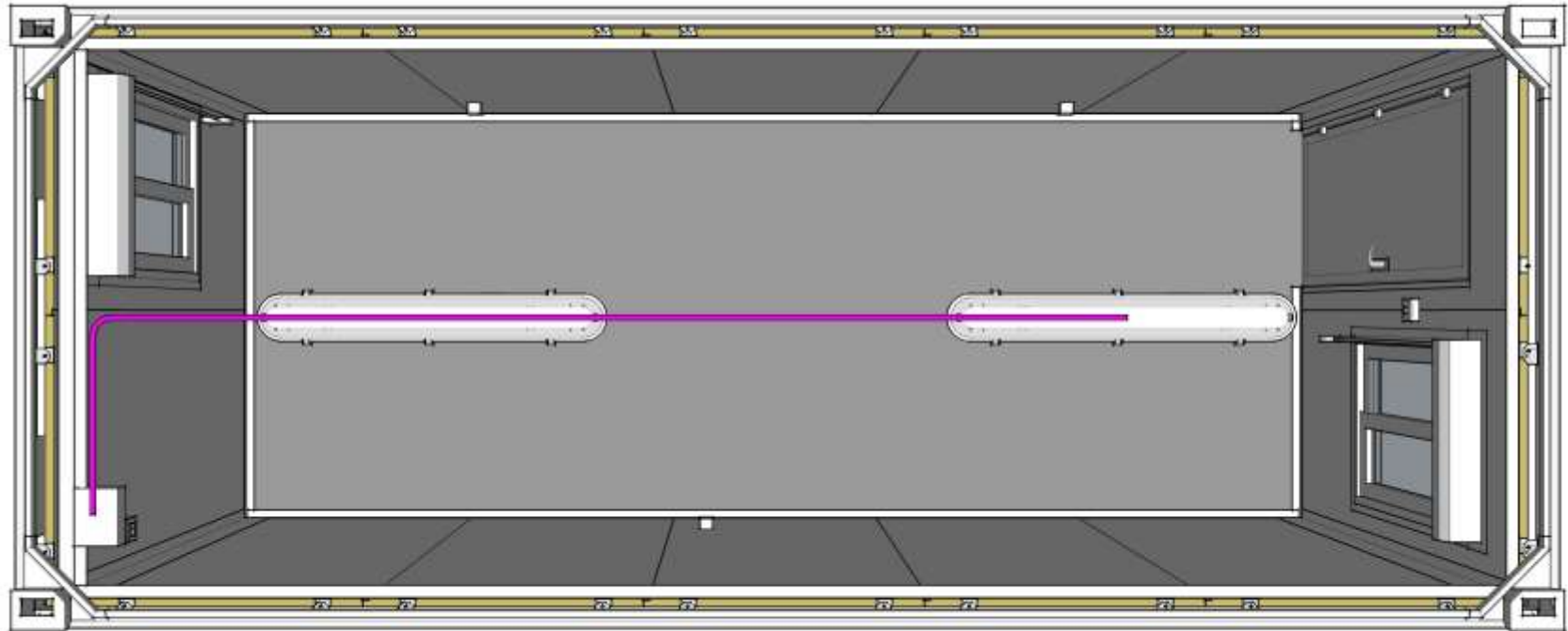

Location of corner post reinforcements

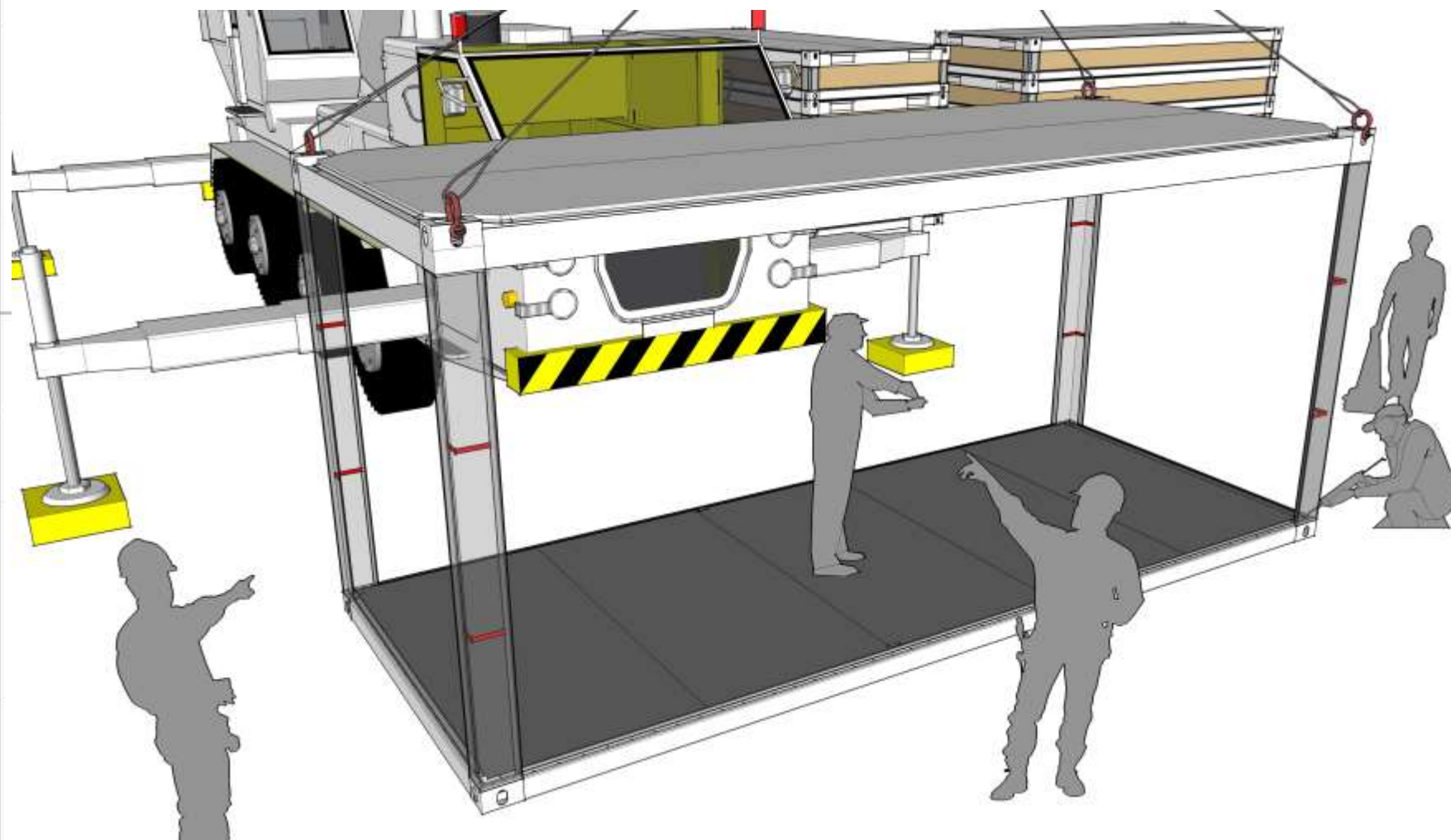



In the **long side**, fix the (L-shape) metal spacer with M4x20 screws to the corner post reinforcements to position the panel.

Distance is approx. 130 mm

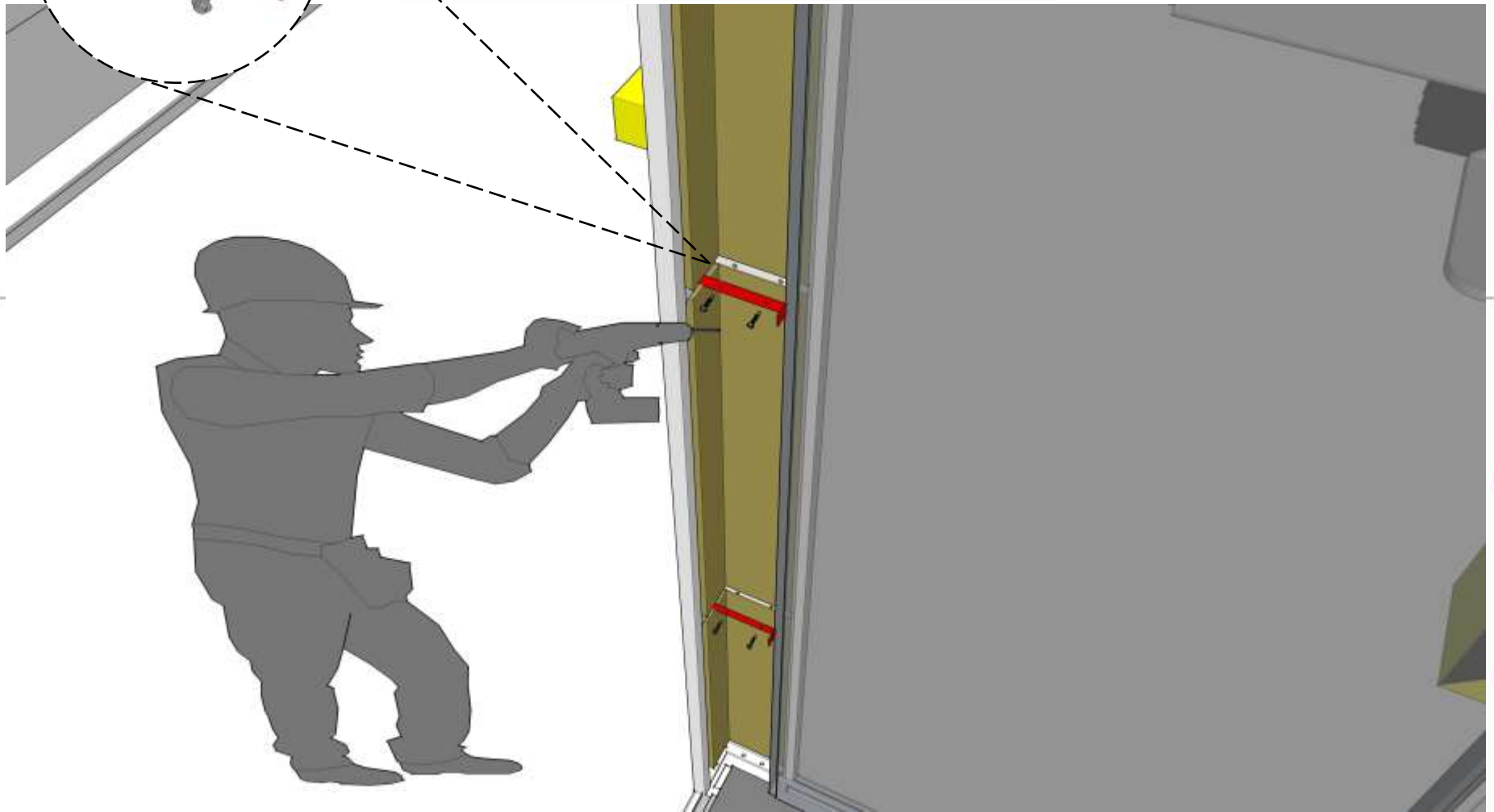

Insert the locking plates on the panel top threaded rods

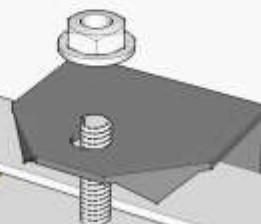

Tighten the locking plates with M8 bolt and washer

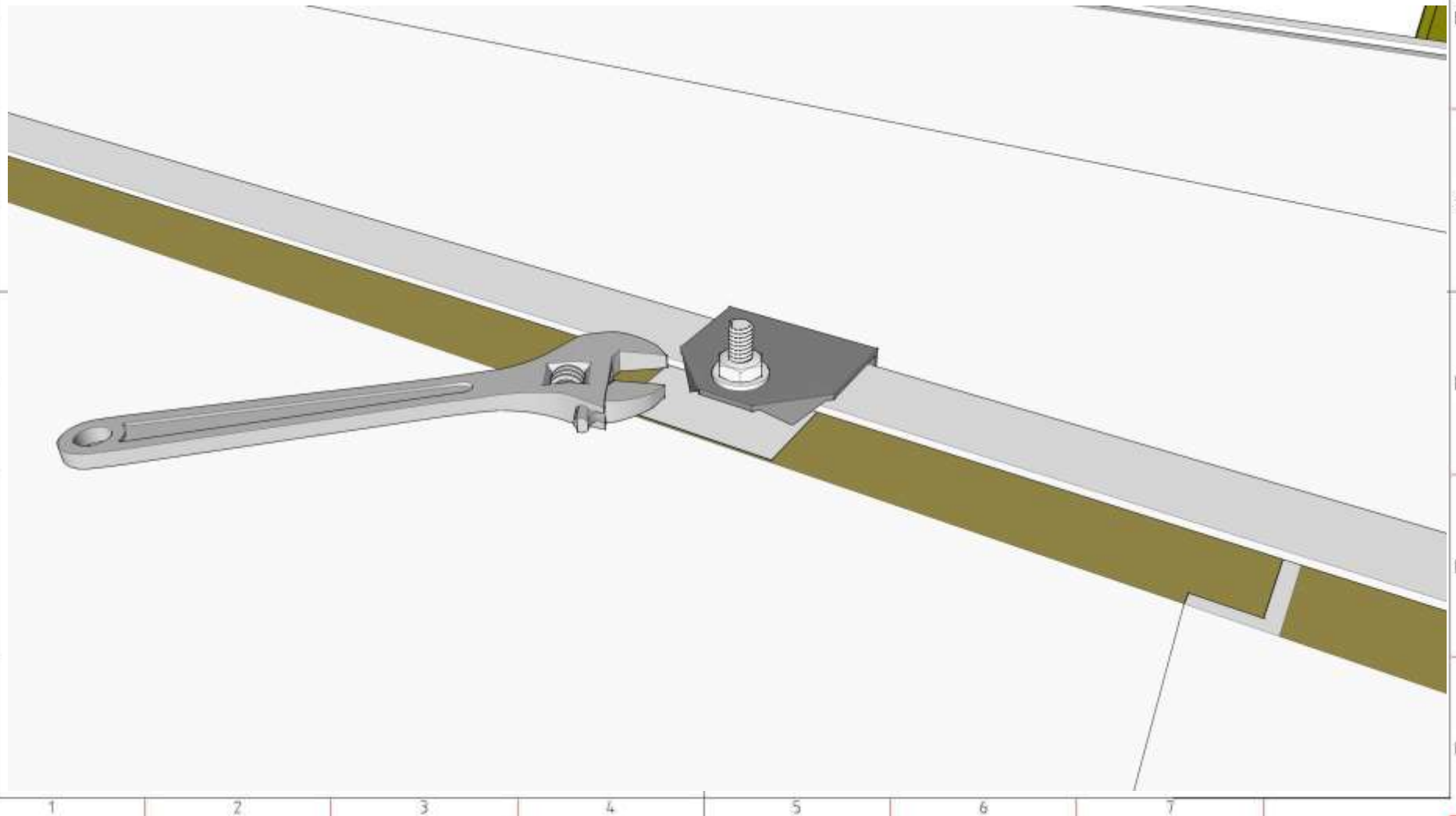

Install the M10 full threaded iron rod on the middle of the long side (location is after the 2<sup>nd</sup> and after the 3<sup>rd</sup> wall panel)

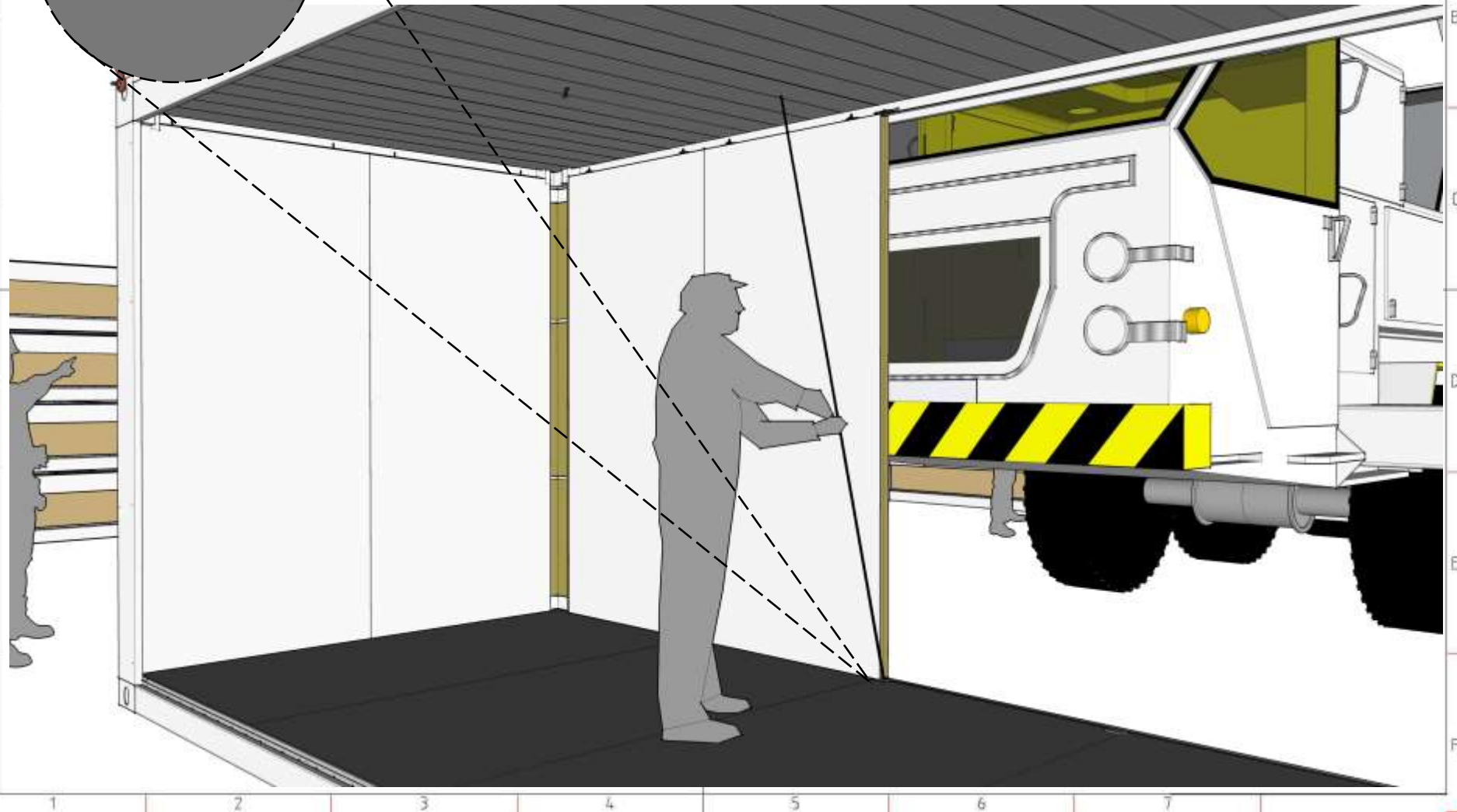
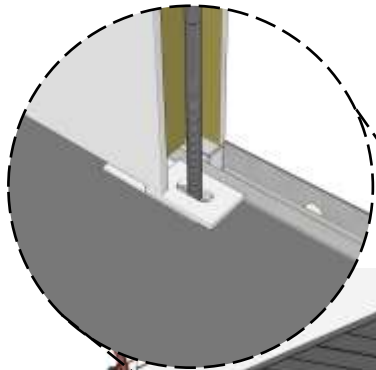

Insert the threaded iron rod locking plate

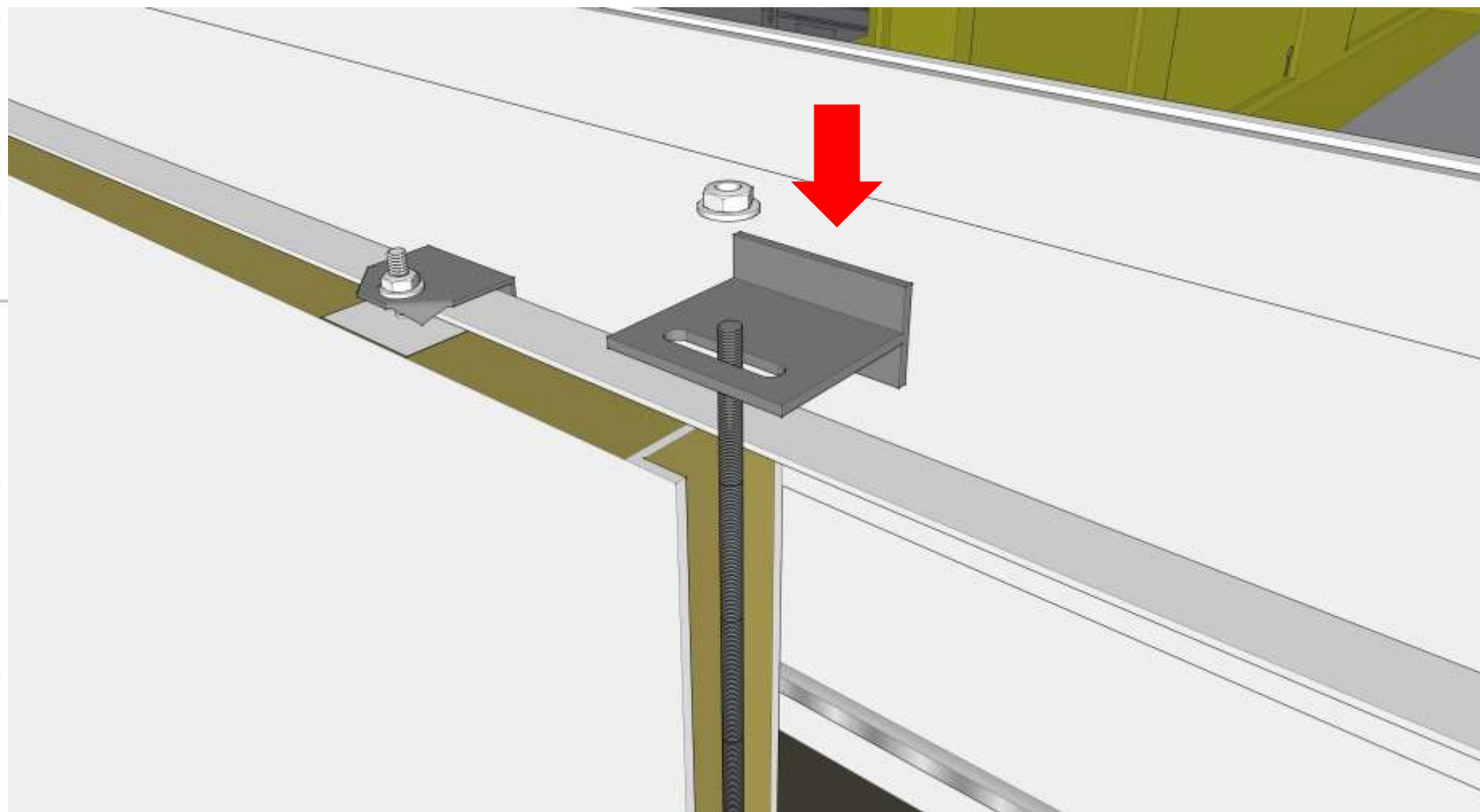



Tighten it with M10 bolt and washer

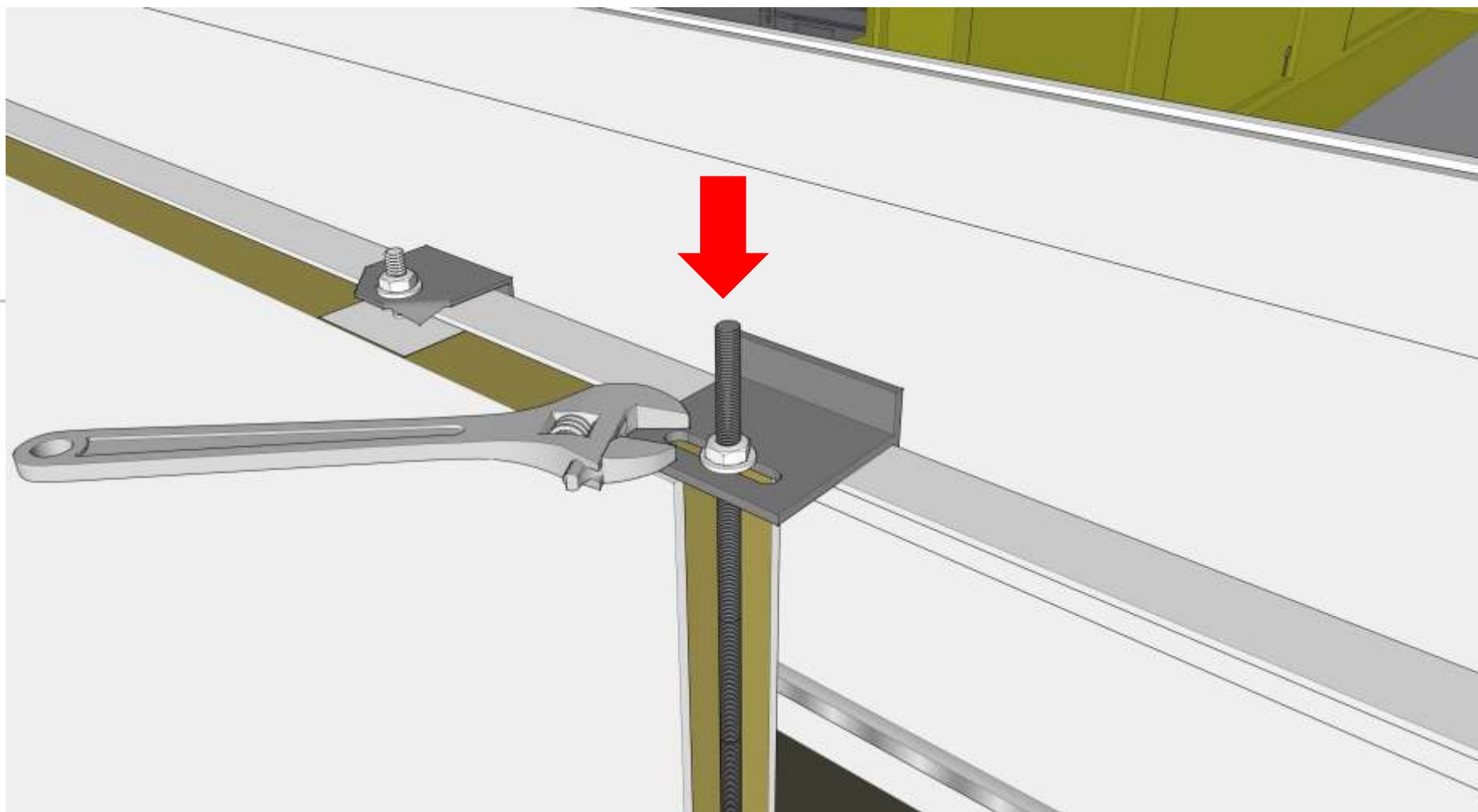

Wall panels are interchangeable, however, this will affect the position of sockets and switches and length of electric cables



In **short side**, position the panel  
40 mm from the corner post

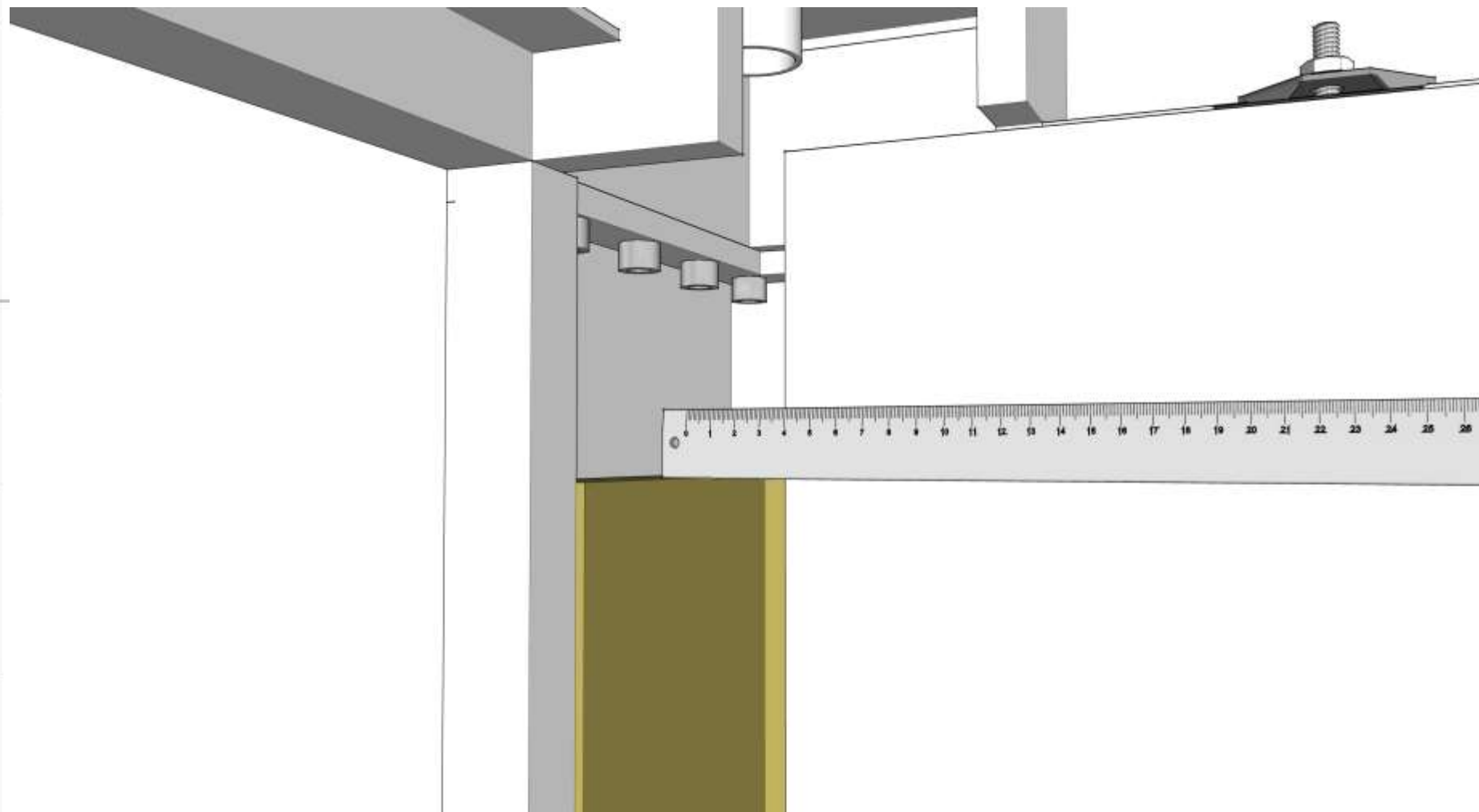

Install panels, door/s and window/s as per approved drawings

Note:  
Electric cables are  
Installed in between  
Wall panels

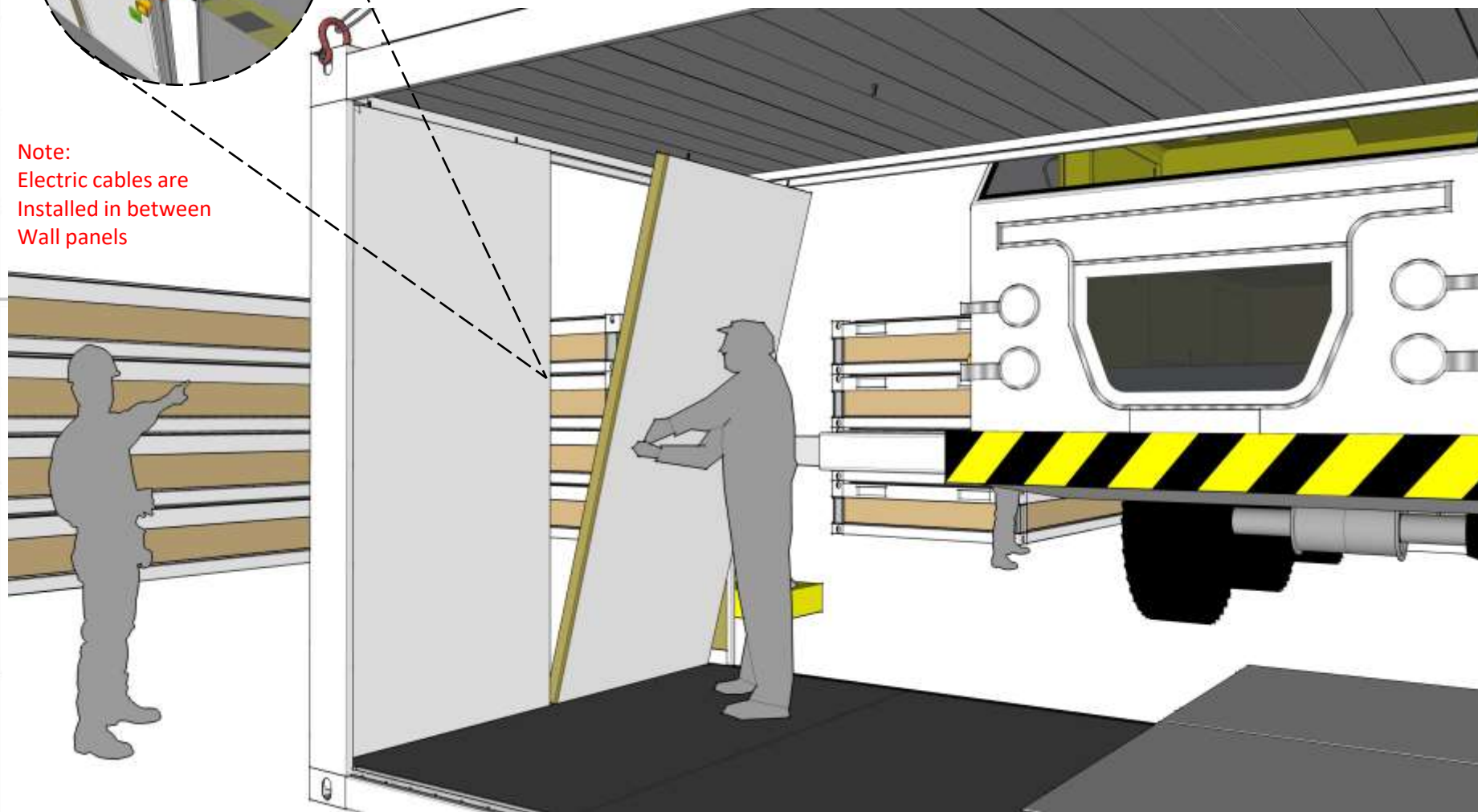

Drill a 5cm hole in the corner post reinforcements





Fix the end panels with 90mm long screws

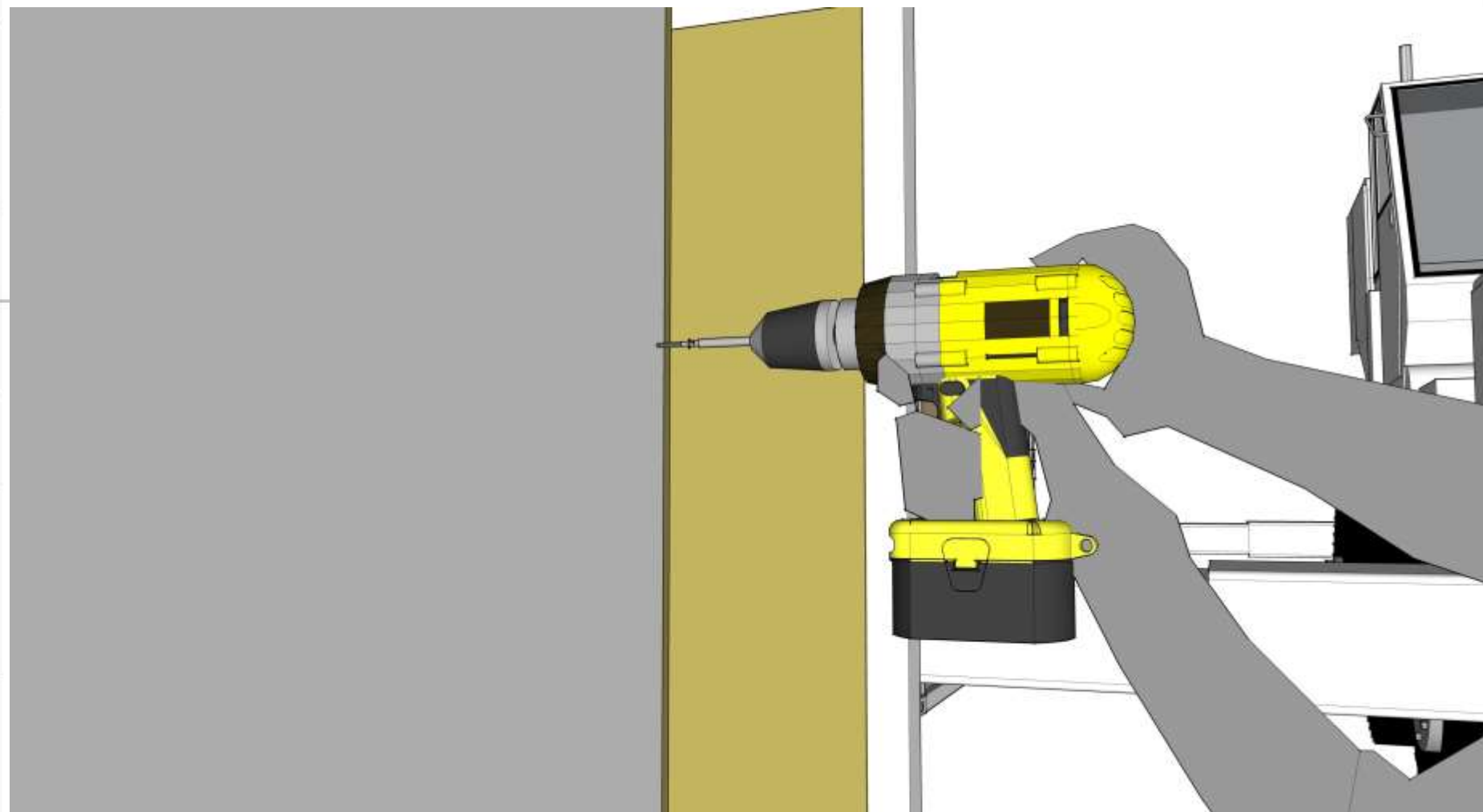

Fit the PVC drain pipes on 4 corners –  
Insert the bottom part, then bend it a little and push top  
end to upper corner



Wiring system for units with **Sandwich mineral wool panels**

Cables installed in between panels

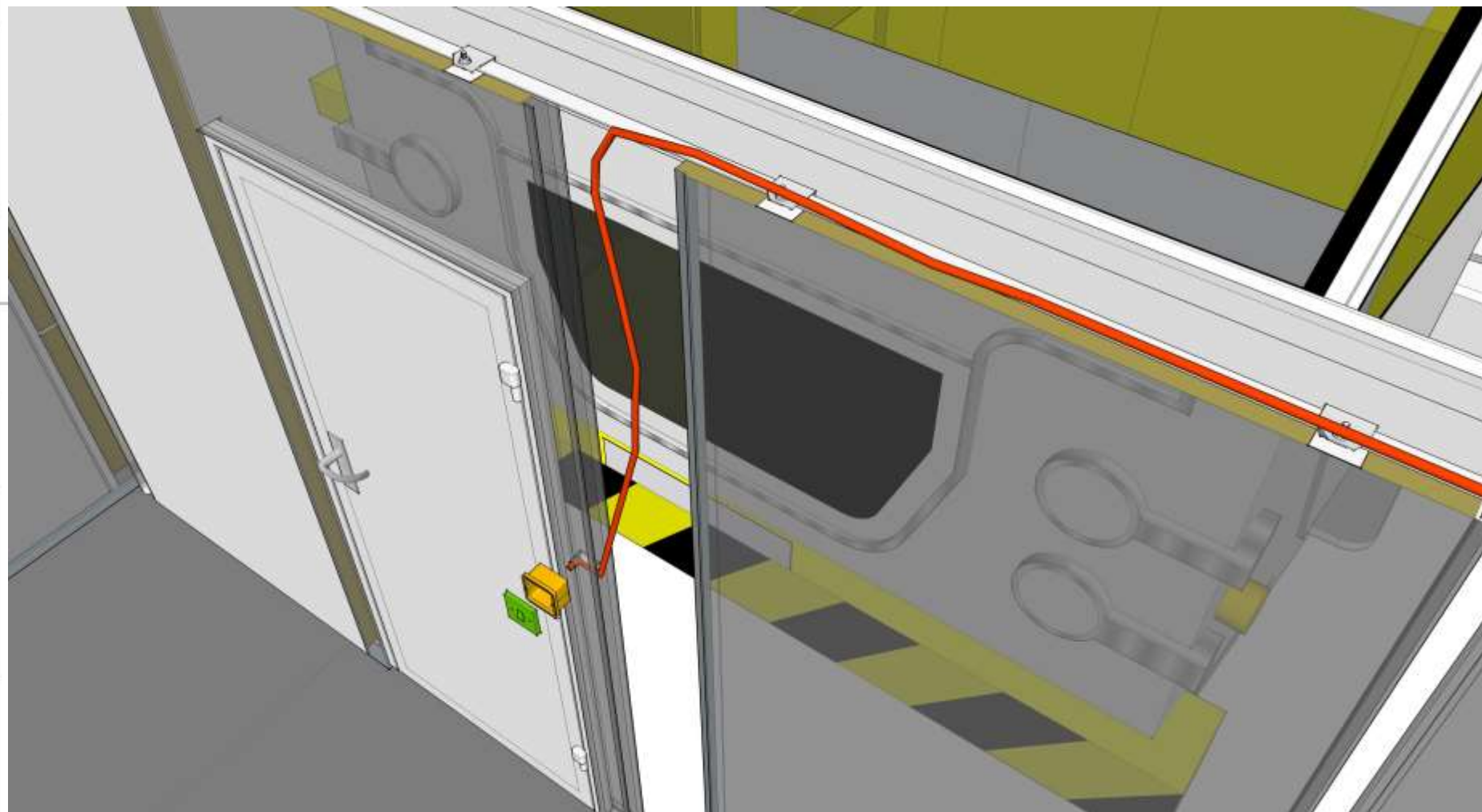

Wiring system for units with Sandwich mineral wool panels

Cables installed in between panels

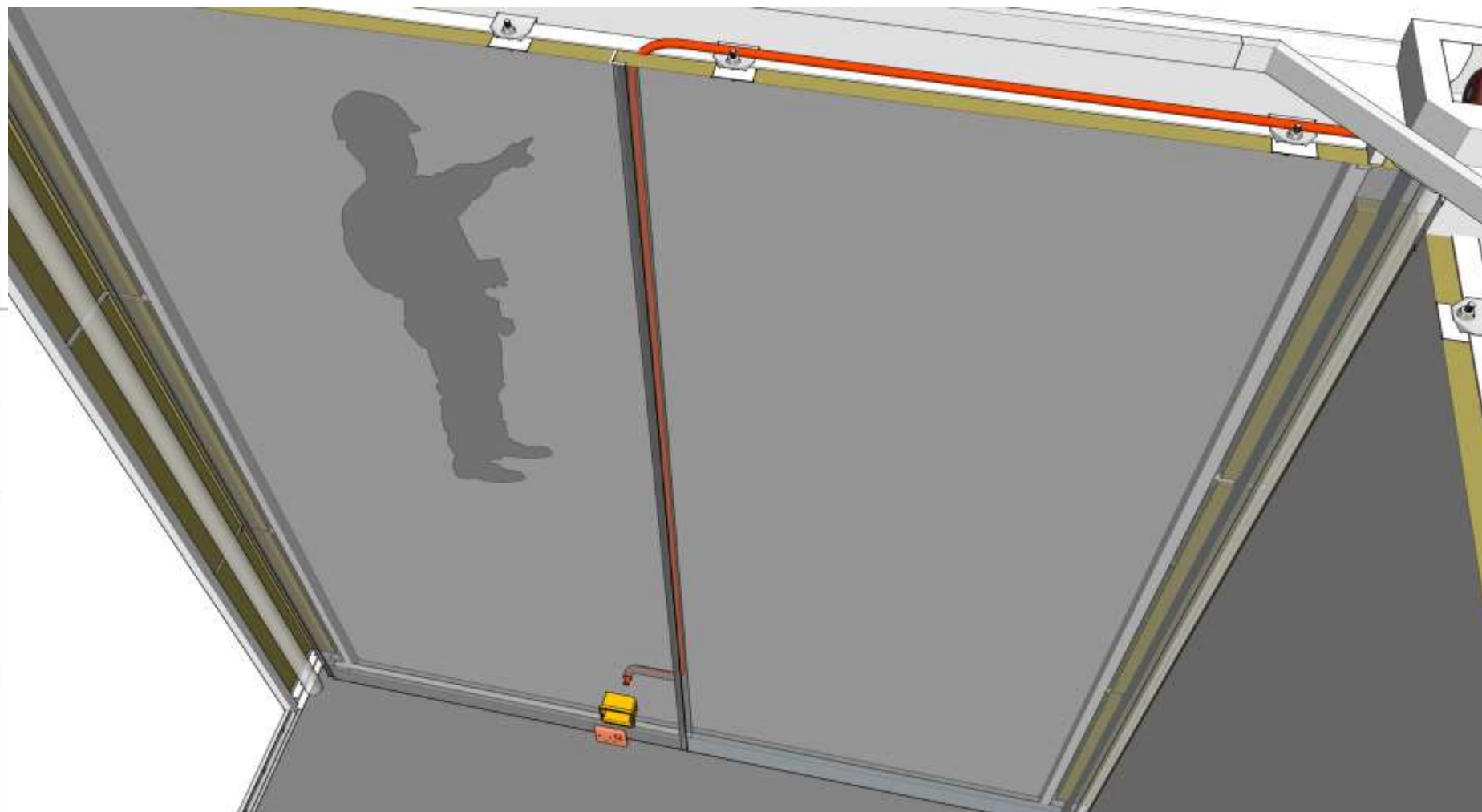

Wiring system for units with  
**Chipboard panels**  
Insert pre-wired conduits into junction box

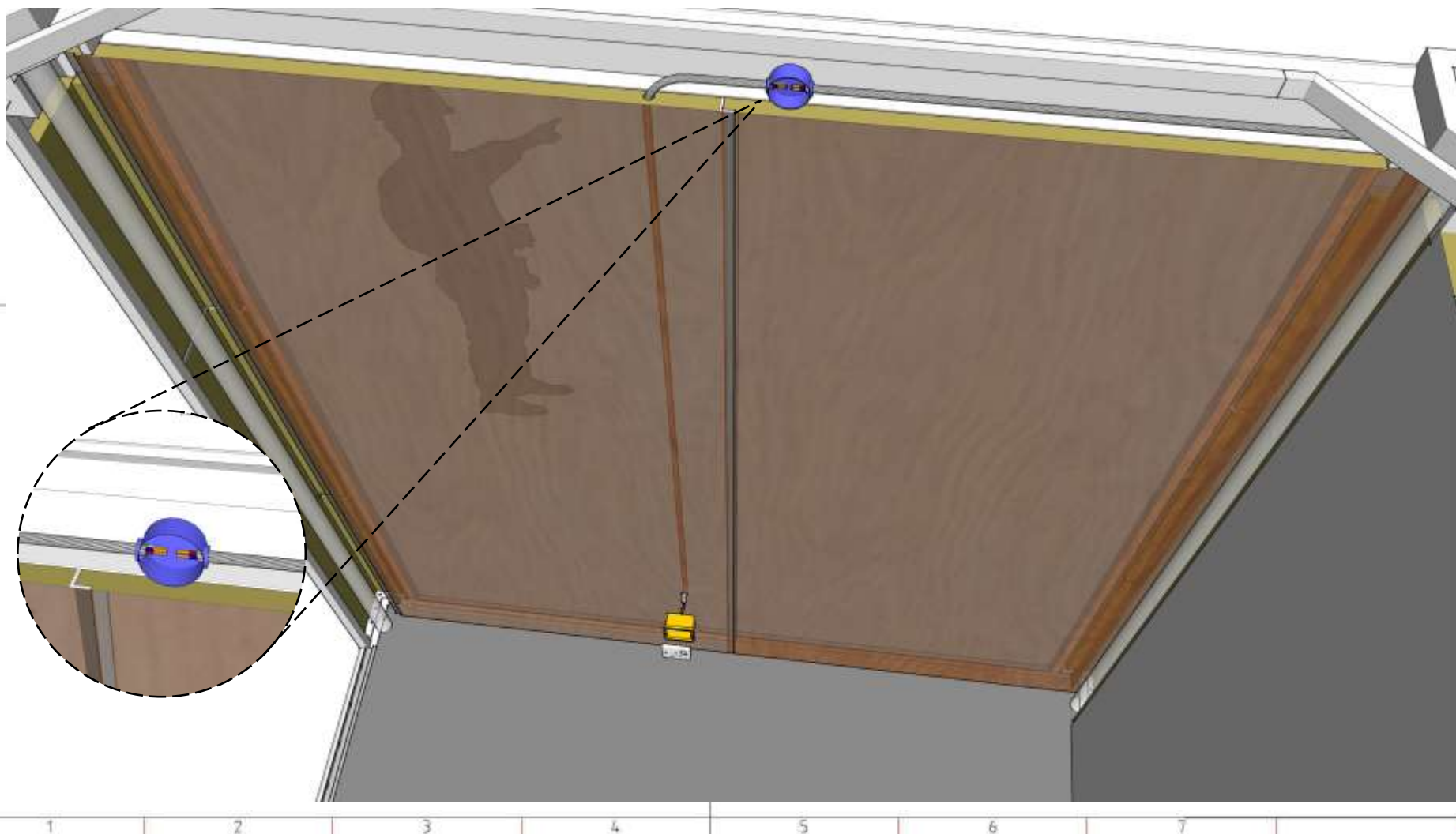



Wiring system for units with  
**Chipboard panels**  
Plug cables in the connector

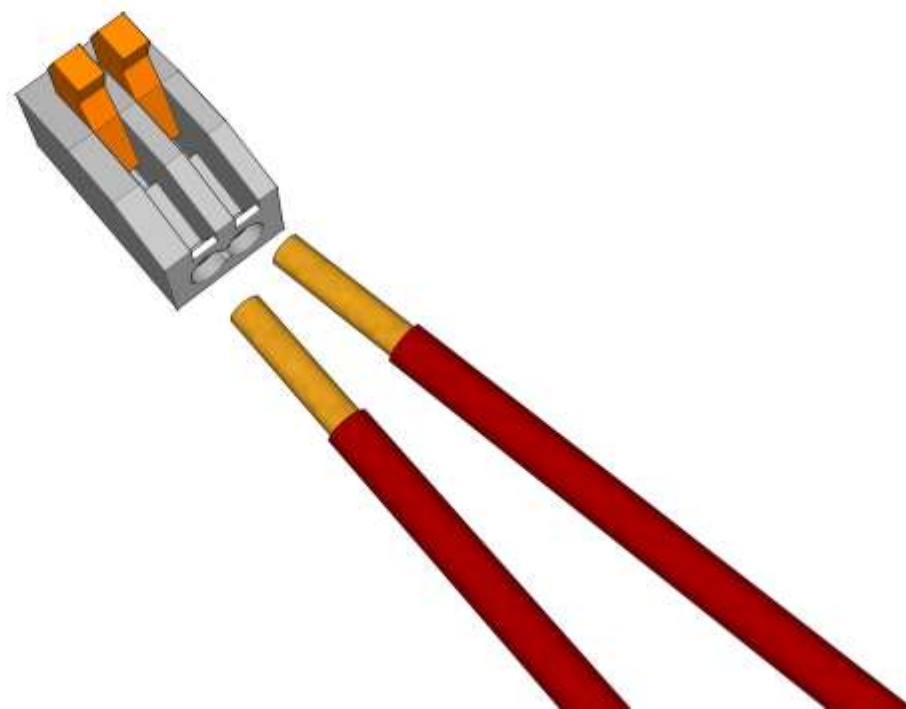

Wiring system for units with  
**Chipboard panels**  
Connect all poles (match cable colors)

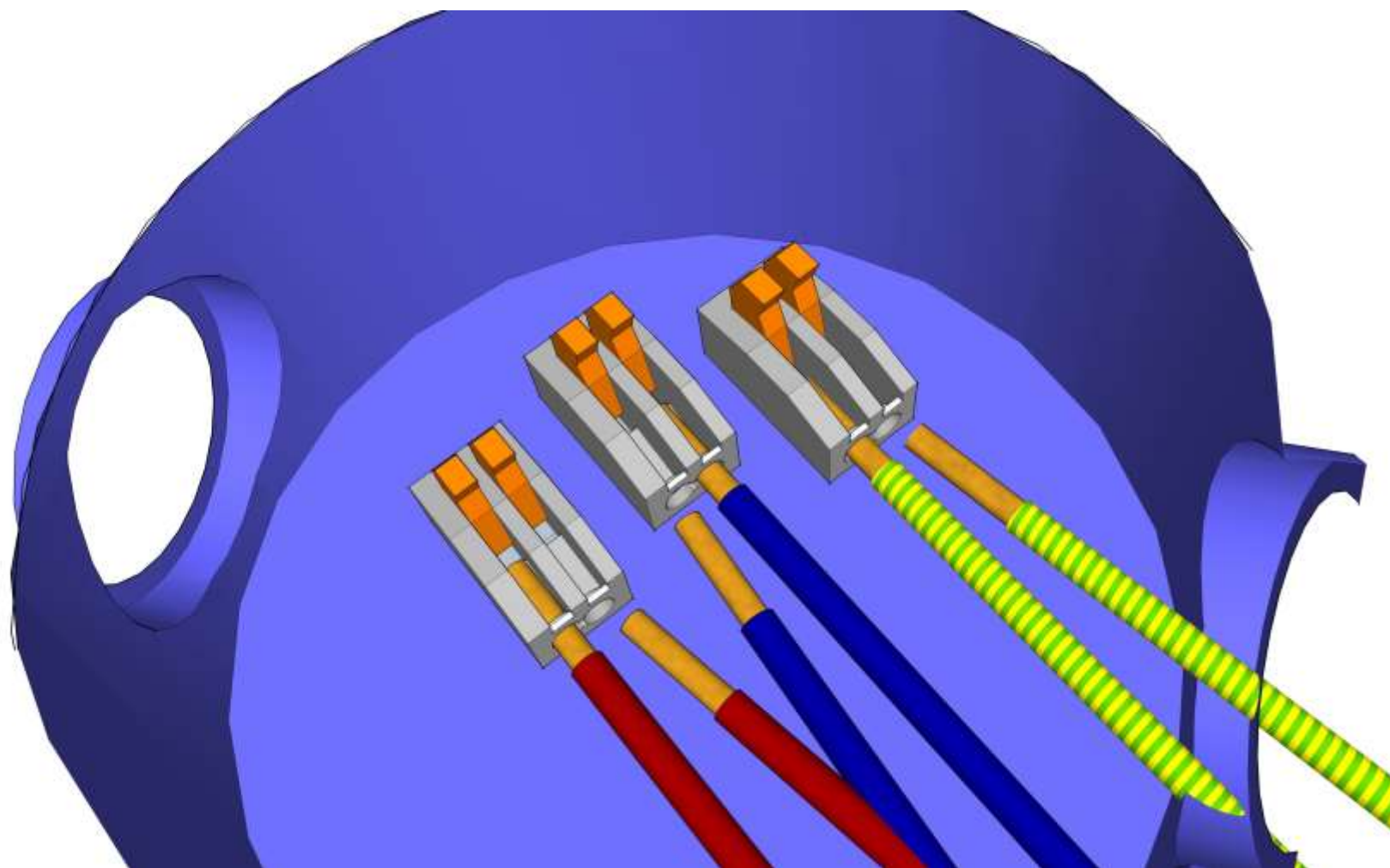

Install lighting fixtures on ceiling



Pull the cables through the panel pre-drilled holes

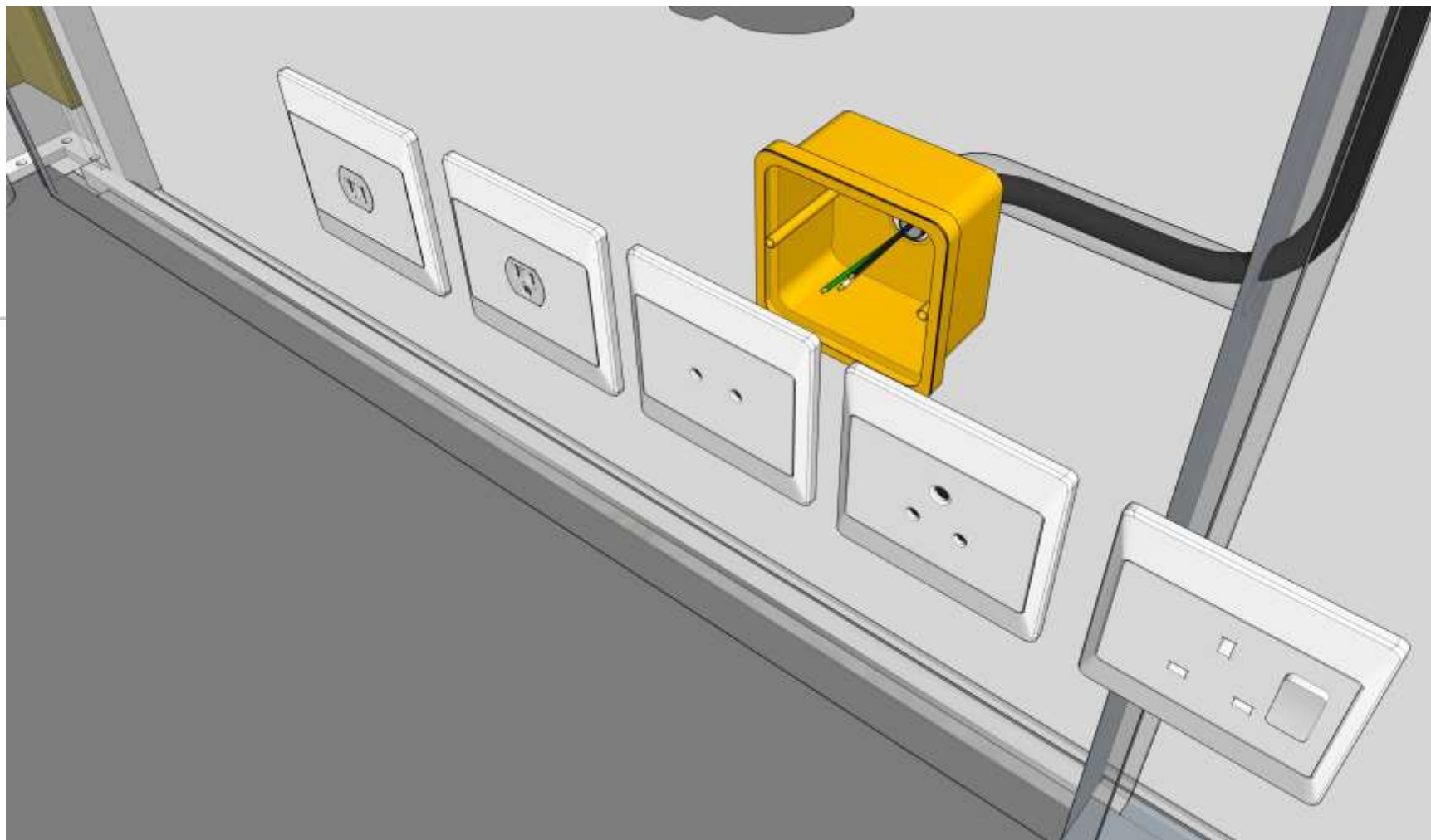

Install the cables to the socket/switch and the cover plate

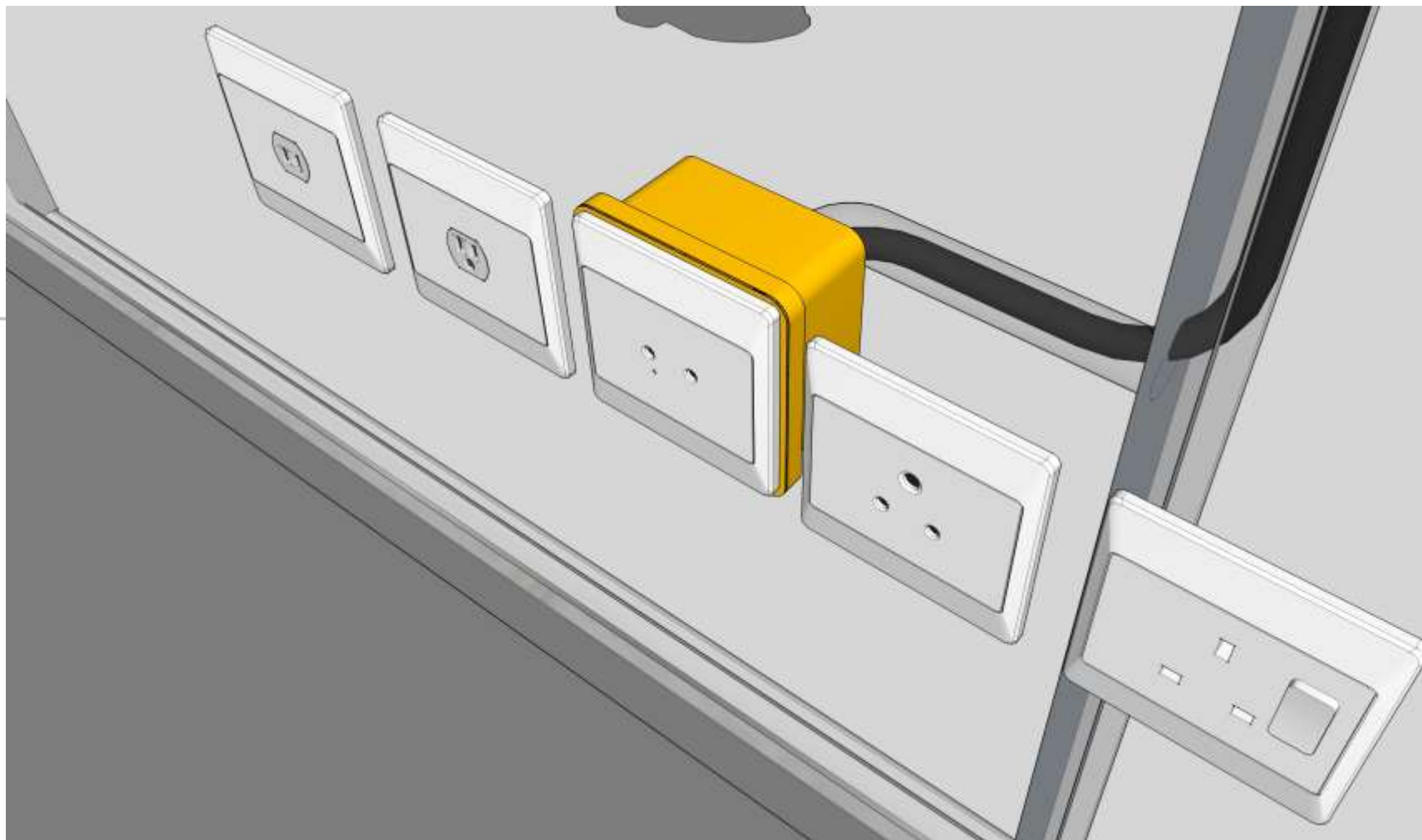



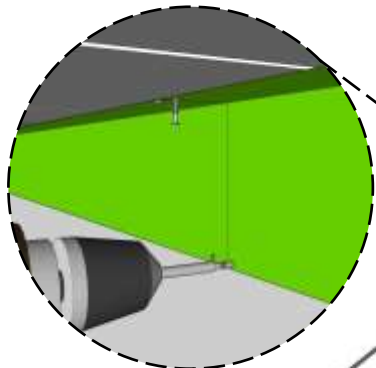

Install the ceiling flashings. Use M5 x 35 and M5 x 90 screws



Install the steel skirtings.  
Use M4 x 20 screws

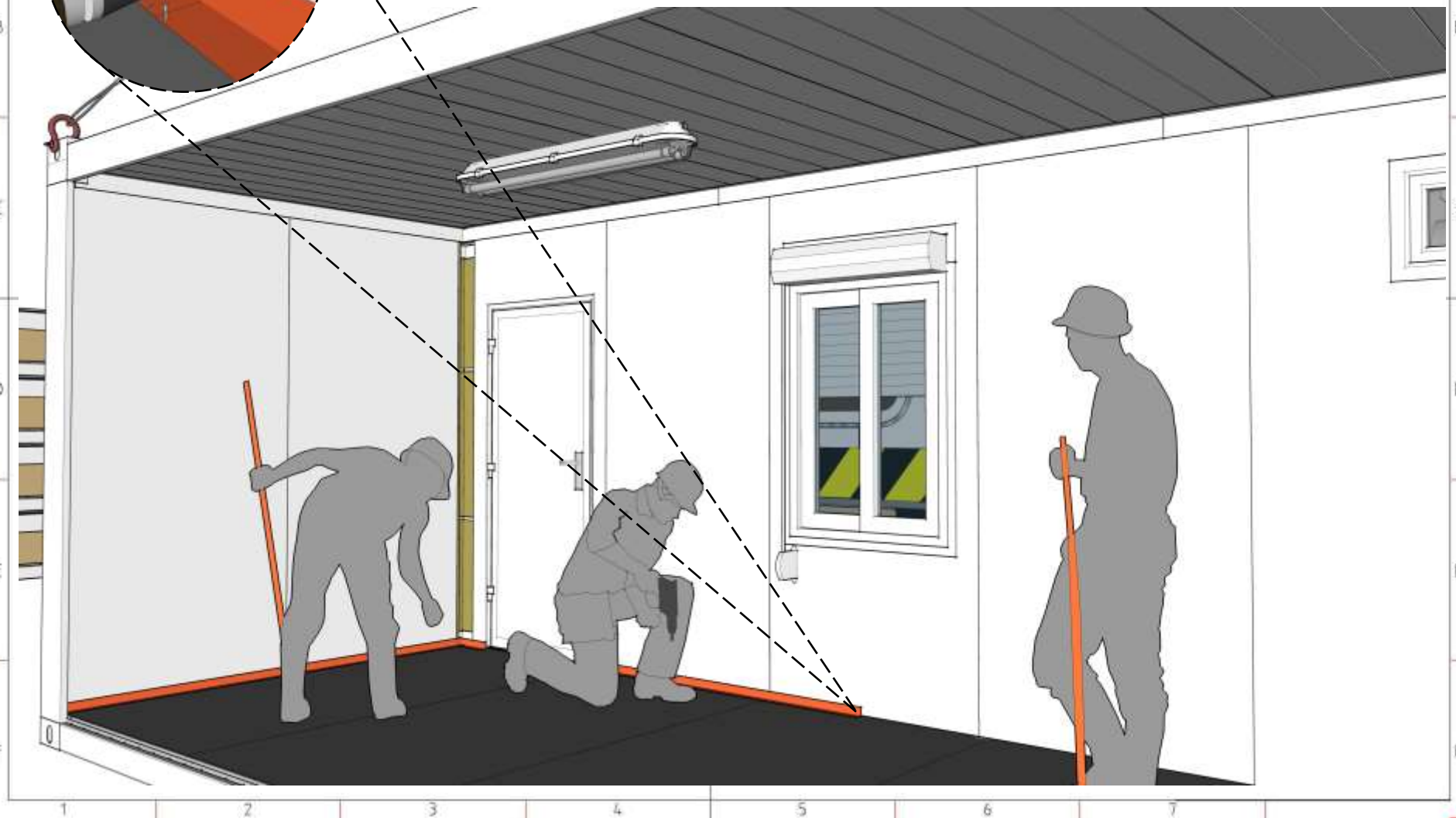
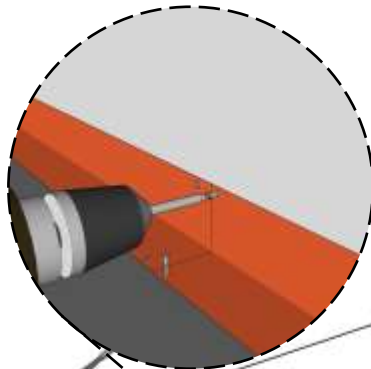

Install corner flashings in 4 corners.  
Use M5 x 35 screws

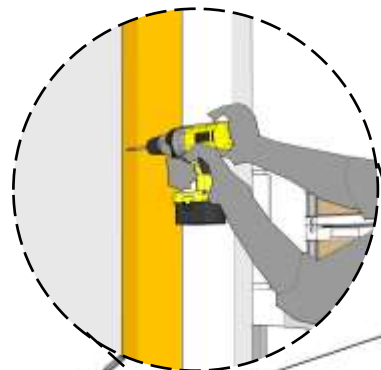

Install the external rubber door stopper

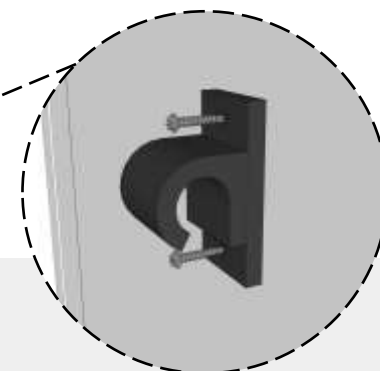
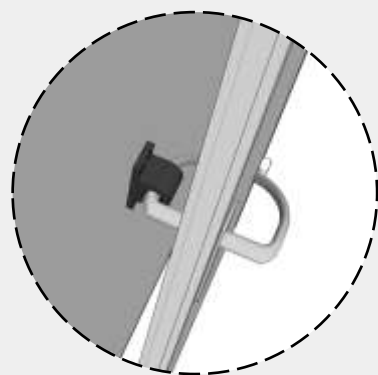

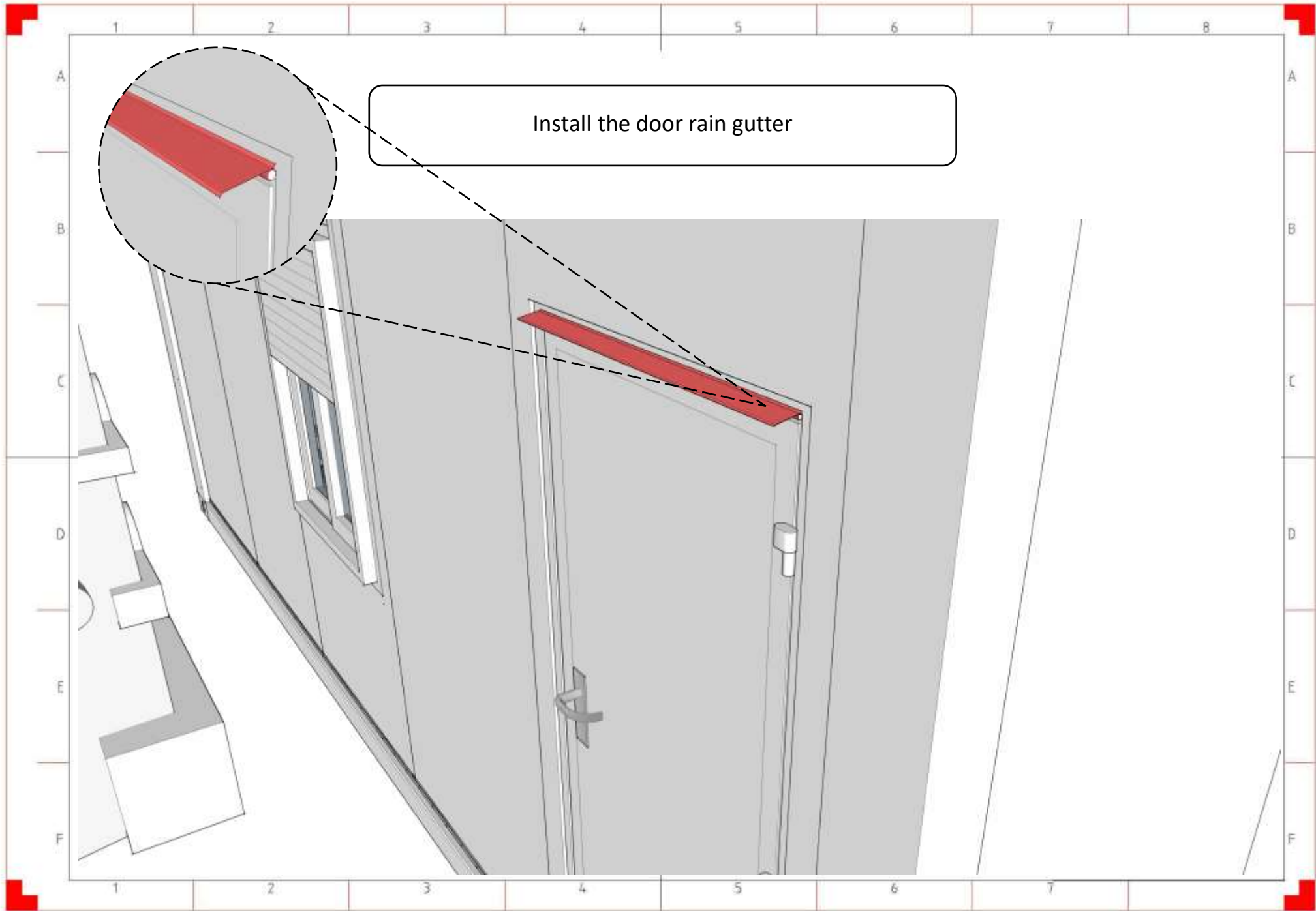

Install the door rain gutter



